

KitchenAid® Food Waste Disposer

PRODUCT MODEL NUMBER

KCDB250G KCDS100T
KCDI075V KBDS100T
KCDS075T

Electrical: This disposer is intended to be direct-wired to the electrical supply. If a junction box is used, connect the junction box to the switch on a separate 15- or 20-amp 115 Volt circuit with the appropriate cable. (Use 14 gauge wire with 15-amp circuit, and 12 gauge wire with 20-amp circuit.) This disposer requires a switch marked "Off" position (wired to disconnect all ungrounded supply conductors) installed within sight of the disposer sink opening. (1 hp minimum rating.)

OVERALL DIMENSIONS

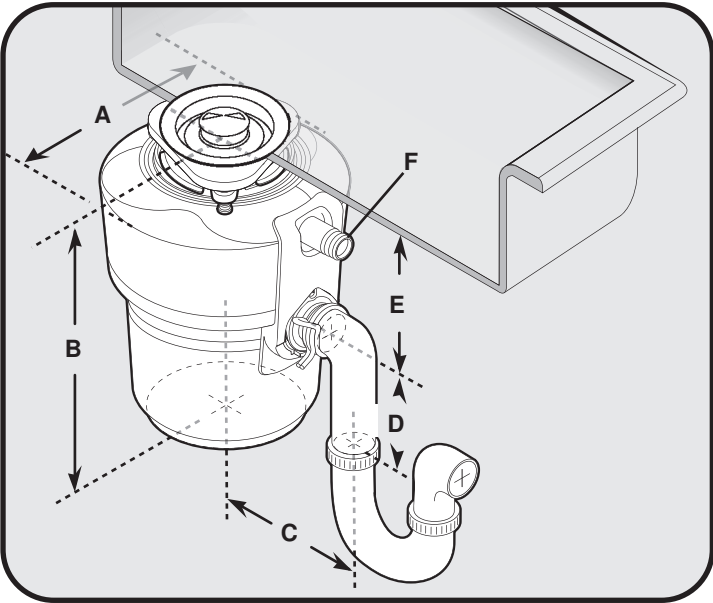

| | KCDB250G | KCDI075V | KCDS075T | KCDS100T | KBDS100T |
|---|-----------------------------|----------------------|----------------------|----------------------|----------------------|
| A | 6 5/16" (16.0 cm) | 8 1/2" (21.6 cm) | 9" (22.9 cm) | 9" (22.9 cm) | 9" (22.9 cm) |
| B | 11 3/8" (28.9 cm) | 12 3/4" (30.5 cm) | 12 3/4" (30.5 cm) | 12 3/4" (30.5 cm) | 15 1/2" (39.4 cm) |
| C | 5 3/4" (14.6 cm) | 5 3/4" (14.6 cm) | 5 3/4" (14.6 cm) | 5 3/4" (14.6 cm) | 5 3/4" (14.6 cm) |
| D | 4" (10.2 cm) | 4" (10.2 cm) | 4" (10.2 cm) | 4" (10.2 cm) | 4" (10.2 cm) |
| E | 6" (15.2 cm) | 6 11/16" (17 cm) | 6 11/16" (17 cm) | 6 11/16" (17 cm) | 9 7/16" (24 cm) |
| F | Dishwasher Drain Connection | | | | |

Installations on thicker sinks (such as solid surface, porcelain, or cast iron) may require the use of alternate parts. See instructions below for installation with various thicknesses:

FIGURE A: Thin Sink
All Models
($< \frac{3}{8}$ ")

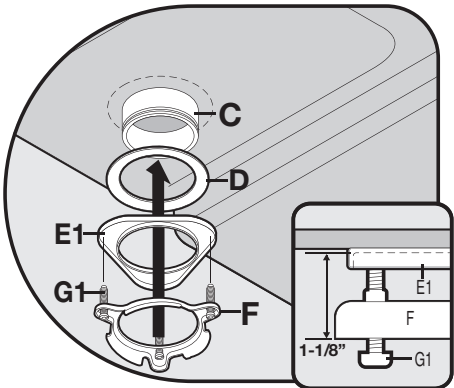

For thin sinks insert fiber gasket (D), backup flange (E1) and mounting ring (F). Hold in place while inserting the snap ring.

C = Standard Sink Flange
G1 = 1 1/2" screws
G2 = 1 1/8" screws

FIGURE B: Thick Sink
All Models
($> \frac{3}{8}$ ")

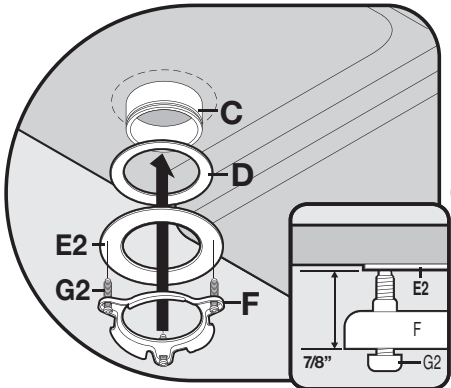

For thick sinks insert fiber gasket (D), backup flange (E2) and mounting ring (F). Hold in place while inserting the snap ring.

FIGURE C: Extra Thick Sink
For Model KBDS100T Only
($> \frac{3}{4}$ ")

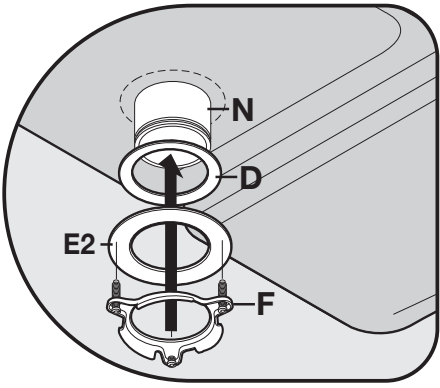

For extra thick sinks use extended sink flange (N), to order in US call 1-800-422-1230, in Canada call 1-800-6777. Insert fiber gasket (D), backup flange (E2) and mounting ring (F). Hold in place while inserting the snap ring.