



## Whirlpool® 1.0 cu. ft. Black All-In-One Multifunctional Countertop Microwave With Air Fry - 900 watt

WMCS5522RB

### Available Finishes/Colours



WMCS5522RB  
Black



WMCS5522RS  
Stainless Steel

This 900 watt countertop microwave oven puts versatility first with All in One cooking modes including Air Fry, Grill Mode, Roast Mode and Combi. Its modern easy-to-use design and 1.0 ft. capacity fits most meals while not taking up too much countertop space, and its Dishwasher-Safe Turntable Plate makes for easy cleanup.

### Top Features

All-in-One

Air Fry

Grill

### Manuals & Literature:



[Dimension Guide](#)



[Owners Manual](#)



[Warranty Information](#)

Dimensions		Microwave Details	
Depth	19.56	Interior Width	13.94
Height	11.81	<b>Features</b>	
Width	21.19	Sensor Cooking	No
<b>Microwave Details</b>		Clock	Yes
Cooking Power Watts	900	Convenience Cooking Controls	Yes
Turntable Diameter Size In	12.4	Cooking Items Included	Turntable
Cavity Finish	Stainless	Number Of Power Levels	10
Convection	Yes	<b>Specifications</b>	
Convection Power Watts	1,450	Add 30 Seconds	Yes
Grill	Yes	Soften Melt	Yes
Grill Power Watts	1,200	Convect	Yes
Interior Depth	13.5	Grill	Yes
Interior Height	9.44	Popcorn	Yes
Interior Light	Incandescent	Defrost	Yes
		Keep Warm	Yes
		Steam Cook	Yes

# Dimension Guide

## MICROWAVE OVEN

### PRODUCT DIMENSIONS

MODEL #	WMCS5022RB / WMCS5022RS	
Unit of Measurement	in	cm
Overall Width (A)	21 <sup>3</sup> / <sub>16</sub>	53.8
Overall Height (B)	11 <sup>13</sup> / <sub>16</sub>	30
Height of the door (C)	11 <sup>1</sup> / <sub>8</sub>	28.3
Depth without door (D)	17 <sup>1</sup> / <sub>8</sub>	43.5
Depth with door (E)	19 <sup>9</sup> / <sub>16</sub>	49.7
Depth with door open 90° (F)	34 <sup>5</sup> / <sub>16</sub>	87.2

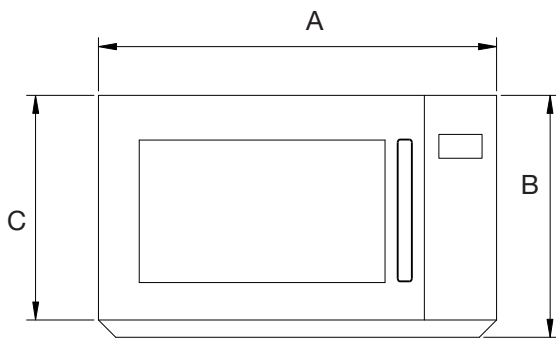

FRONT VIEW

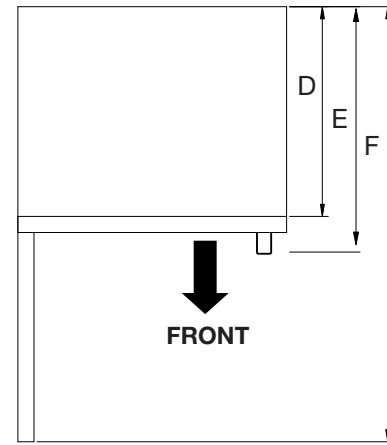

TOP VIEW

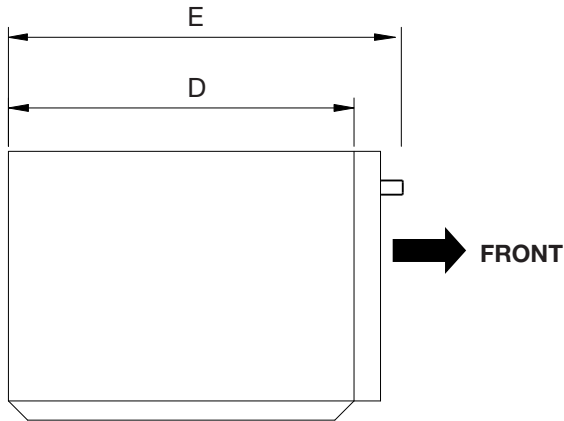

SIDE VIEW

# Dimension Guide

## MICROWAVE OVEN

### MICROWAVE INTERIOR CAVITY DIMENSIONS

MODEL #	WMCS5022RB / WMCS5022RS	
Unit of Measurement	in	cm
Cavity Height (A)	9 <sup>7</sup> / <sub>16</sub>	24
Cavity Width (B)	13 <sup>15</sup> / <sub>16</sub>	35.4
Cavity Depth (C)	13 <sup>1</sup> / <sub>2</sub>	34.3

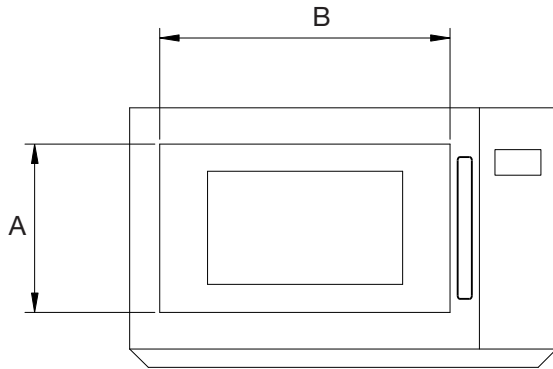

CAVITY INTERIOR FRONT VIEW

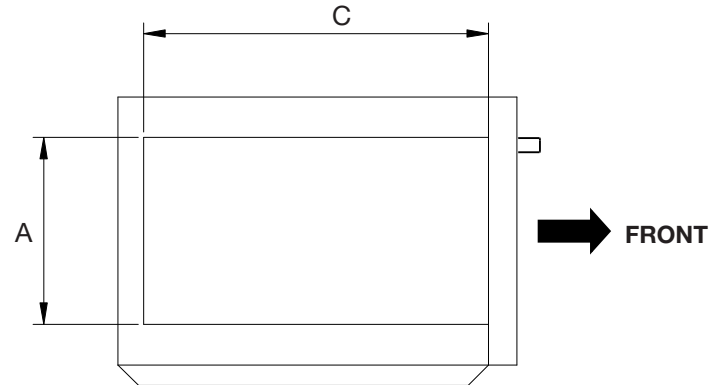

CAVITY INTERIOR SIDE VIEW

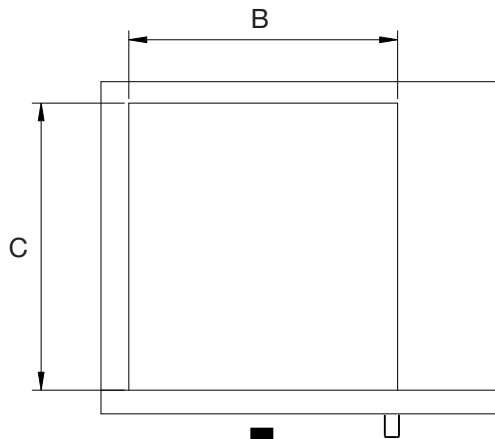

CAVITY INTERIOR TOP VIEW

**NOTE:** Specifications subject to change without notice.

## FOUR À MICRO-ONDES

### DIMENSIONS DU PRODUIT

No de modèle	WMCS5022RB / WMCS5022RS	
	po	cm
Largeur totale (A)	21 <sup>9</sup> / <sub>16</sub>	53.8
Hauteur totale (B)	11 <sup>13</sup> / <sub>16</sub>	30
Hauteur de la porte (C)	11 <sup>1</sup> / <sub>8</sub>	28.3
Profondeur sans porte (D)	17 <sup>1</sup> / <sub>8</sub>	43.5
Profondeur avec porte (E)	19 <sup>9</sup> / <sub>16</sub>	49.7
Profondeur avec porte ouverte à 90° (F)	34 <sup>5</sup> / <sub>16</sub>	87.2

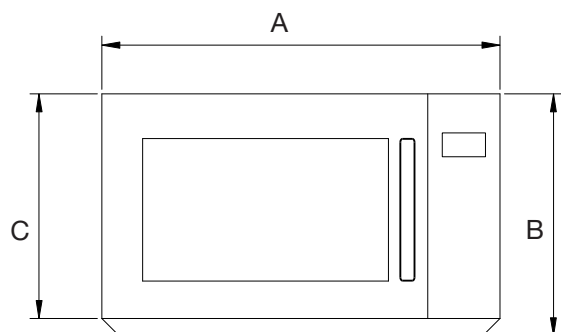

VUE DE FACE

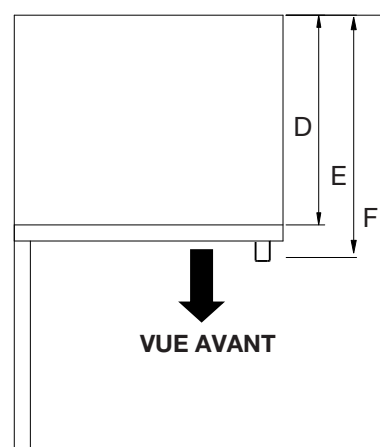

VUE DU DESSUS

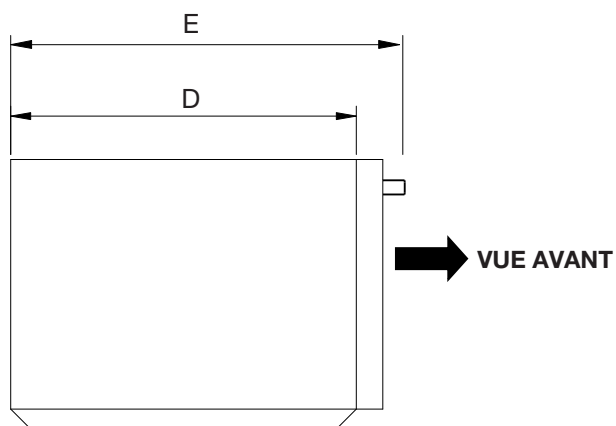

VUE LATÉRALE

## FOUR À MICRO-ONDES

DIMENSIONS DE CAVITÉ DU FOUR À MICRO-ONDES

No de modèle	WMCS5022RB / WMCS5022RS	
Unité de mesure	po	cm
Hauteur de la cavité (A)	9 <sup>7</sup> / <sub>16</sub>	24
Largeur de la cavité (B)	13 <sup>15</sup> / <sub>16</sub>	35.4
Profondeur de la cavité (C)	13 <sup>1</sup> / <sub>2</sub>	34.3

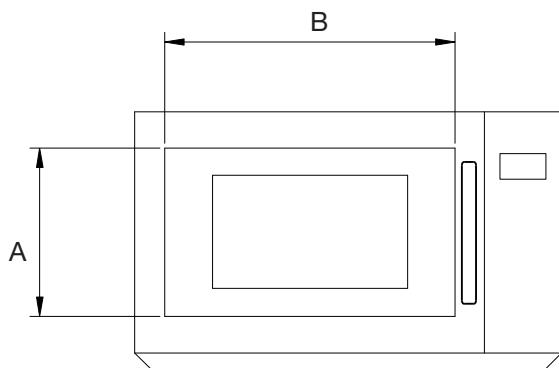

VUE AVANT INTÉRIEURE DE LA CAVITÉ

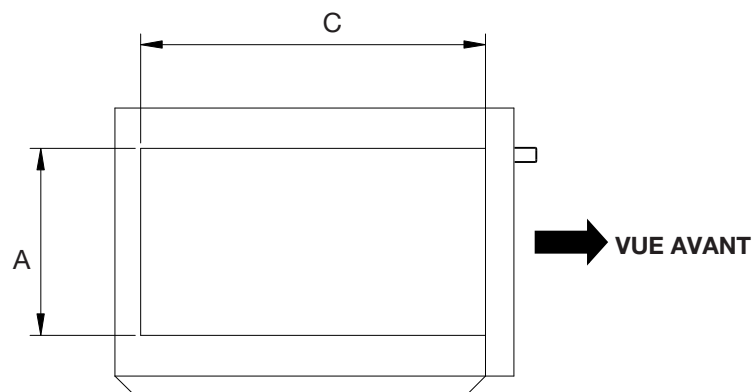

VUE LATÉRALE INTÉRIEURE DE LA CAVITÉ

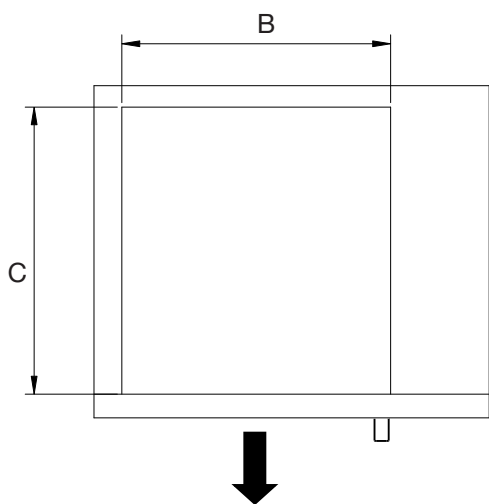

VUE AVANT

VUE DE DESSUS INTÉRIEURE DE LA CAVITÉ

## HORNO DE MICROONDAS

### DIMENSIONES DEL PRODUCTO

N.º DE MODELO	WMCS5022RB / WMCS5022RS	
	pul	cm
Ancho total (A)	21 <sup>3</sup> / <sub>16</sub>	53.8
Altura total (B)	11 <sup>13</sup> / <sub>16</sub>	30
Altura de la puerta (C)	11 <sup>1</sup> / <sub>8</sub>	28.3
Profundidad sin puerta (D)	17 <sup>1</sup> / <sub>8</sub>	43.5
Profundidad con puerta (E)	19 <sup>9</sup> / <sub>16</sub>	49.7
Profundidad con puerta abierta a 90° (F)	34 <sup>5</sup> / <sub>16</sub>	87.2

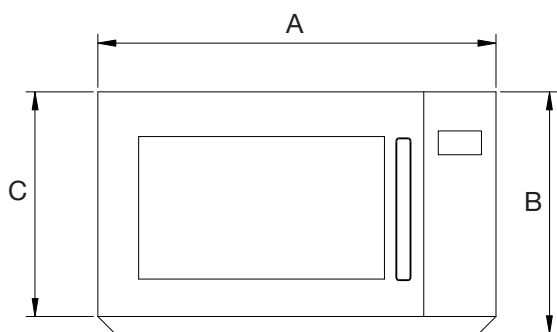

VISTA FRONTAL

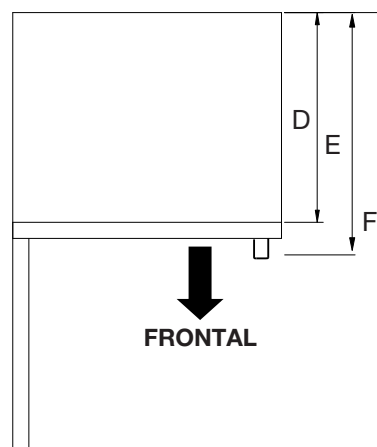

VISTA SUPERIOR

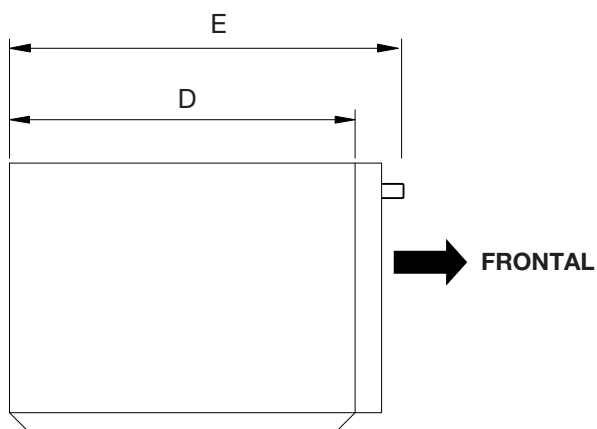

VISTA LATERAL

## HORNO DE MICROONDAS

### DIMENSIONES DE LA CAVIDAD INTERIOR DEL MICROONDAS

N.º DE MODELO	WMCS5022RB / WMCS5022RS	
Unidad de medida	pul	cm
Altura de la cavidad (A)	9 <sup>7</sup> / <sub>16</sub>	24
Ancho de la cavidad (B)	13 <sup>15</sup> / <sub>16</sub>	35.4
Profundidad de la cavidad (C)	13 <sup>1</sup> / <sub>2</sub>	34.3

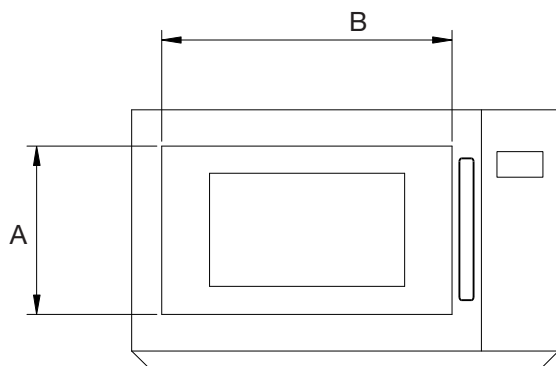

VISTA FRONTAL DE LA CAVIDAD INTERIOR

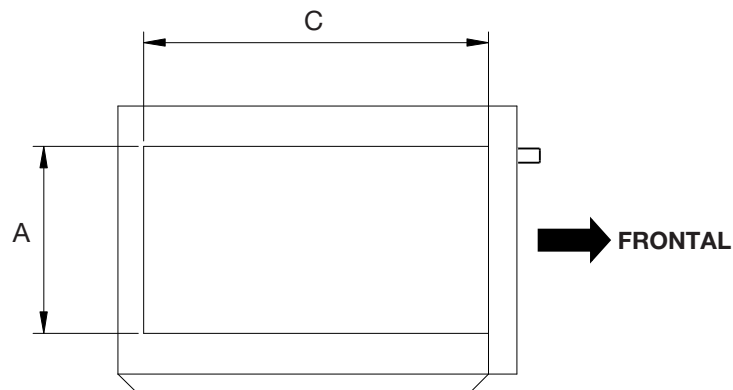

VISTA LATERAL DE LA CAVIDAD INTERIOR

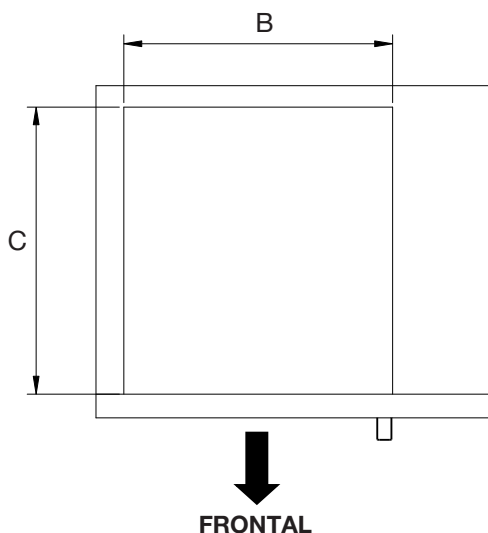

VISTA SUPERIOR DE LA CAVIDAD INTERIOR

**NOTA:** Las especificaciones están sujetas a cambios sin previo aviso.