

# LG Sound Suite

Wi-Fi SPEAKER

## Owner's Manual

Please read this manual carefully before operating your set and retain it for future reference.

M7 / M5

# Speaker Quick Guide

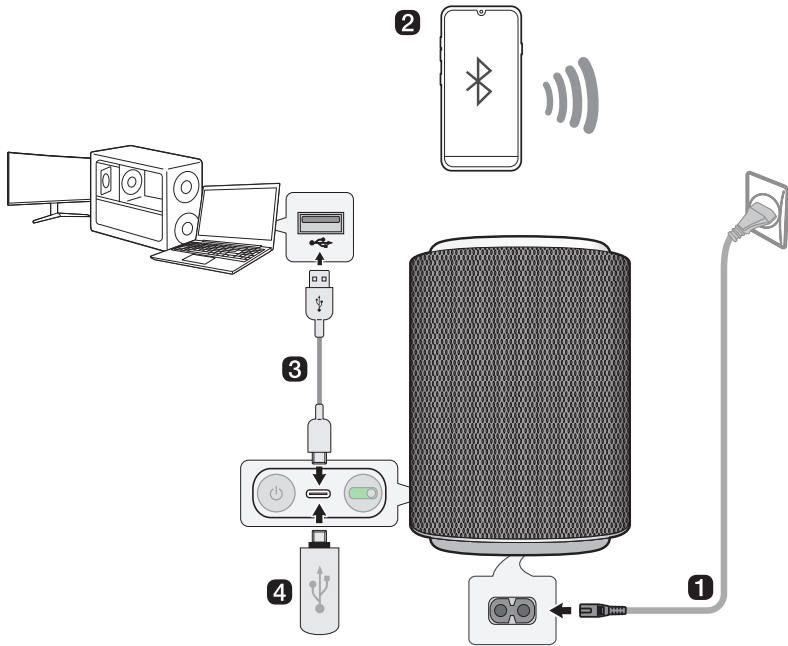

## Connecting and Using the Speaker

- 1** Connect the product using the power cable. The power turns on automatically.



## 2 Connecting the product to your smartphone via Bluetooth (→ See “Connecting via Bluetooth”)

---

- 1 Press the **Source**  button repeatedly on the product until the lighting indicator lights up blue to select **Bluetooth** mode. After a moment, the lighting indicator blinks blue.
- 2 Tap the **Settings**  button on your smartphone and select **Bluetooth**. Turn on the **Bluetooth** function. ( **Off** >  **On**)
- 3 Find and select “LG Sound Suite Series model name”.
- 4 When the product is connected to your smartphone via **Bluetooth**, the lighting indicator lights up blue.
- ! If the product does not appear in your smartphone’s **Bluetooth** search, press and hold the **Source**  button on the product for more than 2 seconds while in **Bluetooth** mode.

## 3 Connecting the product to a PC using a USB 2.0 Cable (→ See “Connecting via a USB 2.0 Cable”)

---

- 1 Press the **Source**  button repeatedly on the product until the lighting indicator lights up amber to select the USB-Audio mode. After a moment, the lighting indicator blinks amber.
- 2 Connect the product to your PC using a USB 2.0 cable.
- 3 When the product is connected to the playback device, the lighting indicator lights up amber.
- 4 Switch the audio output on your PC to USB audio.
- 5 Select a music app on your PC and start playback.

## 4 Playing Music from the USB (→ See “Connecting to a USB Storage Device”)

---

- 1 Press the **Source**  button repeatedly on the product until the lighting indicator lights up amber to select the USB Drive mode. After a moment, the lighting indicator blinks amber.
- 2 Plug the USB storage device into the USB port on the back of the product.
- 3 When the product is connected to the USB storage device, the lighting indicator lights up amber, and music plays automatically.

## 5 Connecting the product to Wi-Fi (→ See “Connecting with the product via LG ThinQ app”)

---



(Android)



(iOS)



- 1 Connect your smartphone to Wi-Fi.
- 2 Install the **LG ThinQ app** on Google Play or the App Store.
- 3 Run the **LG ThinQ app** and follow the instructions.
- 4 The product will connect to your smartphone and you can control the product with **LG ThinQ app**.

### Using Dolby Atmos FLEXCONNECT

The product connects with LG Sound Suite products to provide optimal acoustics in any room or location. Connectivity is possible through the **LG ThinQ app**'s Dolby Atmos FLEXCONNECT settings without the need for complicated wires. Connect your LG Sound Suite products for optimal acoustics.

Scan the QR code below for more information of using Dolby Atmos FLEXCONNECT with LG Sound Suite products.



---

#### ✔ Note

- W7 requires an LG TV or soundbar with Dolby Atmos FLEXCONNECT support for connection.
    - After registering the soundbar in the **LG ThinQ app**, connect W7 through [Dolby Atmos FlexConnect] in the **LG ThinQ app**. (Refer to the W7 owner's manual for detailed connection instructions.)
  - W7 can be assigned to a Dolby Atmos FLEXCONNECT group, but does not operate in Dolby Atmos FLEXCONNECT mode.
-

# Table of Contents

## Speaker Quick Guide

- 2 Connecting and Using the Speaker

## Exploring the Product

- 6 Front
- 10 Back

## Installation

- 11 Connecting the power
- 12 Installing the Stand (Sold separately)

## Connecting

- 19 Connecting with the product via LG ThinQ app
- 21 Connecting via Bluetooth
- 23 Connecting via a USB 2.0 Cable
- 25 Connecting to a USB Storage Device
- 27 Connecting Stereo Speakers

## Playback

- 29 Compatible with Google Assistant
- 30 Works with Apple AirPlay
- 31 Spotify Connect
- 32 Tidal Connect
- 33 LG radio+

## Various settings for convenience

- 34 Using MY function
- 35 Using Room Calibration Pro
- 37 Using Sound Effects
- 39 Using Ambient lighting
- 40 Using Standby Mode lighting
- 40 Resetting the Product
- 41 Voice/Audio cues feedback function

## Using Dolby Atmos FLEXCONNECT

- 42 About Dolby Atmos FLEXCONNECT
- 45 Dolby Atmos FLEXCONNECT Setup with Soundbar
- 48 Dolby Atmos FLEXCONNECT Setup with LG TV
- 50 Dolby Atmos FLEXCONNECT Connection Combinations

## Safety Precautions

- 54 Safety and Regulatory
- 56 Prevention of product misuse

## Before Reporting Product Malfunction

- 60 Troubleshooting

## Appendix

- 65 Specifications
- 66 Registered Trademarks and Licenses
- 67 What You Need to Know about Network Services
- 67 Open Source Software Notice Information
- 68 Handling the Product

# Exploring the Product

## | Front

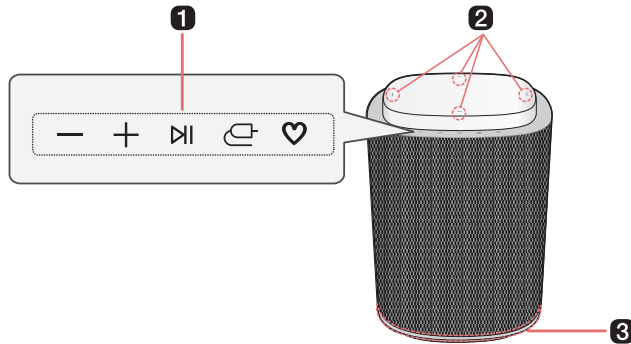

---

### 1 Volume

Adjusts the sound volume.

### Play/Pause

- Play/Pause: Press the button.
- Moving to the next music: Press the button twice quickly.
- Moving to the previous music: Press the button three times quickly.

### Source

Press the button repeatedly to select the desired function or input mode.

- Wi-Fi: Connects the product via Wi-Fi.
- **Bluetooth**: Connects the product via **Bluetooth**.
- Dolby Atmos FLEXCONNECT: Connects the product to other LG Sound Suite products via Dolby Atmos FLEXCONNECT.
- USB: Connects the product via a USB 2.0 cable or USB storage device.

### MY

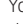
- Press the button to use the **MY** functions. (→ See “Using MY function”) Before using **MY** functions, set up in the **LG ThinQ app**.
- Press the button twice to use Room Calibration Pro. The speaker sound is optimized for your listening space. (→ See “Using Room Calibration Pro”)
- You can press the **Volume**  and **MY**  buttons on the product at the same time to turn the ambient lighting on or off. (→ See “Using Ambient lighting”)

---

### 2 Built-in microphone

This is used when operating the Room Calibration Pro.

---

### 3 Lighting indicator

You can check the speaker’s operation and connection status. (→ See “Lighting Indicator”)

---

---

✔ **Note**

- To reduce power consumption, the product will automatically turn off after 15 minutes of no input signal from an external device.
  - The microphone is used solely for audio functionality and does not collect the user's sound.
- 

---

⚠ **CAUTION**

Note that when using the Room Calibration Pro feature, the sound may suddenly become louder during the stage of optimizing sound quality.

---

# Lighting Indicator

## Power on / Power off



- When the power is turned on, the lighting indicator lights up amber.
- The color of the lighting indicator may differ depending on the selected source.



- When the power is turned off, the middle of the lighting indicator lights up white.
- Currently in standby mode. The product is ready to receive signals or establish network connection.



- When the power is turned off, the lighting indicator turns off.
- Currently powered off. Press the **Power** (⏻) button briefly to start using the product.

## Volume control

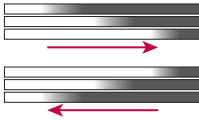

- Volume up: The lighting indicator gradually brightens from left to right.
- Volume down: The lighting indicator gradually dims from right to left.
- When the volume reaches its maximum level, a voice prompt or audio cue is played.

## Source



### Wi-Fi ready

The lighting indicator blinks green.



### Wi-Fi connected

The lighting indicator lights up green.

### Apple AirPlay, Google Cast, Spotify, Tidal connect

When playing music via Apple AirPlay, Google Cast, Spotify, or Tidal Connect, the lighting indicator lights up green.

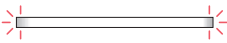

### Stereo mode ready

The lighting indicator blinks white.



### Stereo mode connected (Left)

The left side of the lighting indicator lights up white.



### Stereo mode connected (Right)

The right side of the lighting indicator lights up white.

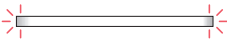







### Dolby Atmos FLEXCONNECT ready

- The lighting indicator blinks white for 30 minutes.
- In Dolby Atmos FLEXCONNECT mode, press and hold the **Source** (Ⓢ) button on the product for more than 2 seconds, and the lighting indicator will blink white for 30 minutes.



### Dolby Atmos FLEXCONNECT connected

The lighting indicator lights up white.

Source	
	<p><b>Bluetooth ready</b> The lighting indicator blinks blue.</p>
	<p><b>Bluetooth connected</b> The lighting indicator lights up blue.</p>
	<p><b>USB audio ready / USB storage device ready</b> The lighting indicator blinks amber.</p>
	<p><b>USB audio connected / USB storage device connected</b> The lighting indicator lights up amber.</p>
	<p><b>Room Calibration Pro in progress</b> The lighting indicator displays dynamic, multicolored light animations.</p>
	<p><b>Room Calibration Pro completed</b> The lighting indicator lights up with multicolored lighting.</p>

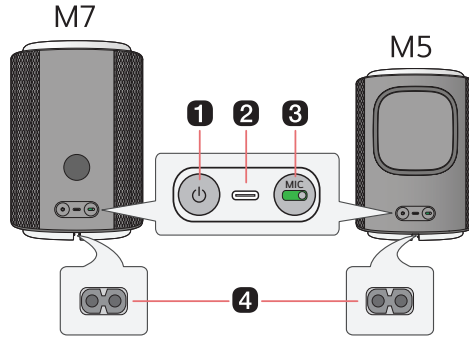

✔ **Note**

Once the connection is complete, the lighting indicator will light up with the ambient lighting color set through the **LG ThinQ app**.



## 1 Power

Turns the speaker on or off.

- If you press and hold the **Power**  button for more than 3 seconds until all button backlights turn on when turning off the product, the Wi-Fi connection will be deactivated. To maintain the Wi-Fi connection, briefly press the **Power**  button to turn off the product.

## 2 USB Audio port

Plug in a USB (Type-C) audio cable to connect the product to your PC and play music through it.

### USB port

Plug in a USB (Type-C) storage device to play music with the product.

## 3 MIC (Microphone) switch

Switch the microphone on or off.

- The Room Calibration Pro functions are not available when the MIC switch is in OFF state.

## 4 AC IN

Plug in the power cord.

## ✓ Note

- The microphone is used solely for audio functionality and does not collect the user's sound.
- The microphone is used only for the Room Calibration Pro feature and is not used for the Dolby Atmos FLEXCONNECT calibration.

# Installation

## | Connecting the power

- 1 Plug the power cable into the **AC IN** port on the bottom of the product, then organize the cable.

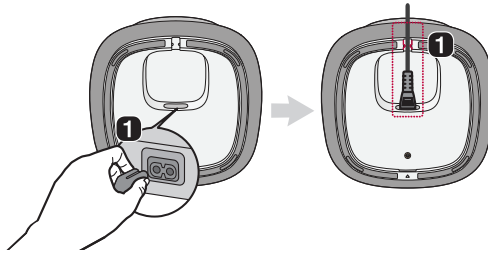

- 2 Plug the power cable connected to the product into an outlet. The power turns on automatically.

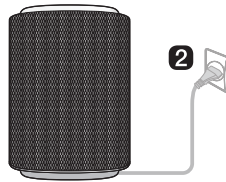

## | Installing the Stand (Sold separately)

You can install this product on the stand.

When Installing the product on the stand, follow the instructions below.

### Checking before installing the stand

---

#### **Please check the following first.**

- The following stands can be used depending on the speaker model.
  - M7: FS-M71(Stand × 1), FS-M72(Stand × 2)
  - M5: FS-M51(Stand × 1), FS-M52(Stand × 2)
  - The number of components may vary depending on the stand model.
- The stand does not include a power cord. Use the power cord included with the Sound Suite speaker, or purchase a separate power cord from LGE.COM. (Separate power cord length: 3.5 m (11.5 ft))
- When assembling, ensure that all of the provided screws are attached. If the screws are not fully tightened, the product may tilt or tip over, resulting in damage. Tightening the screws with excessive force may cause them to come off due to abrasion of the screw joint.
- Please note the following when you install the product on the stand. Product damage or injury may occur during the process.
  - Do not put objects on top of the product installed on the stand.
  - Secure the product firmly to the stand so that it does not fall off.
  - Ensure it is out of the reach of children. Pulling or shaking the installed product may cause it to fall.

## Components for installing the product

---

Speaker



Stand pole



Top plate

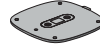

Stand base

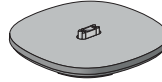

Screws **A**

- M4 x 15 mm (0.59 inch)



Screw **B**

- M4 x 8 mm (0.31 inch)



---

### **⚠ Safety information**

- Read this manual carefully before installation to ensure proper setup.
  - After installation, store the manual in a location where it can always be accessed by the user.
- 

### **⚠ Warning**

- The product should be installed where its weight can be fully supported.
    - If the product is installed on a weak surface, it may fall, causing injury.
  - After installation, ensure that children do not hang from or climb on the product. Avoid giving the product any strong impact.
    - The product may fall and cause injury.
  - Do not step on or climb onto the stand (corners).
    - Deformation of the stand may cause malfunction or injury to your feet (toes).
  - When rotating, moving, or handling the product with the stand and speaker attached, ensure that no one is nearby. Always hold the stand base and stand pole firmly with both hands during handling.
    - Handling the product by holding the speaker may cause it to detach from the stand, leading to the product falling, damage, or injury.
  - Make sure not to let the power cord get caught between the stand base, the stand pole, the top plate, and the speaker. The power cord may be damaged, resulting in fire, electric shock, or damage to the product.
- 

### **⚠ Caution**

- Follow the instructions in this Installation Manual to properly install the product.
    - If you do not follow the instructions in the Installation Manual the product may be installed incorrectly and cause serious injury or damage the product.
  - Do not clean the product with wet towels or place heaters or humidifiers underneath it.
    - Moisture entering the product or steam and heat may result in fire, electric shock, or damage to the product.
  - Wear work gloves when installing the product and do not use your bare hands.
    - Otherwise, this may cause injury.
  - Check whether the floor is solid and level enough to support the product before installation, and use the screws provided when installing.
    - If you use screws other than those specified by the manufacturer, they may not be able to hold the weight of the product, and this may cause safety hazards.
    - The product may fall and cause damage or malfunction.
  - Keep the product away from sprinklers, detectors, high-tension wires, power sources, or places where vibrations or shock from impact are likely to occur.
  - When moving or handling the product with the stand attached, take care to avoid it toppling over, which could result in damage or external damage to the appearance.
-

---

## **⚠ Before Installation**

- The stand does not include a power cord. Use the power cord included with the Sound Suite speaker, or purchase a separate power cord from LGE.COM. Issues related to product damage or safety accidents that may occur as a result of using other power cords will not be covered.
  - Do not use this product for any purpose other than installing the stand on the speaker.
  - This product is designed for installing certain speakers. Check the model name of your speaker and never install it on anything other than a designated speaker.
  - When installing/using the stand, be careful of product damage and safety accidents due to carelessness.
  - It is convenient to install the stand according to the installation guide.
  - If the instructions in the manual are unclear, stop installing and contact a service center.
  - Check that the accessories provided with the product are all included before installing. Any damage to or loss of accessories after the inner packaging has been opened will not be covered.
  - Make sure that the accessories are kept out of the reach of children to prevent safety hazards such as suffocation due to the swallowing of small parts.
  - Make sure that all screws are fully tightened. Tightening the screws with excessive force may cause them to come off due to abrasion of the screw joint. The product may fall and cause damage or injury.
  - To prevent any safety hazards, take care when handling tools during the installation.
  - Only install the speaker with this product on a solid, level floor. Do not install the product on weak or slanted floors, or on walls. Issues that may occur as a result of installing the product on weak or slanted floors or on walls will not be covered.
-

## Installing the Product on the stand

- 1 Attach the stand pole to the stand base, then firmly secure the connection using two screws **A** (M4 x 15 mm (0.59 inch)).

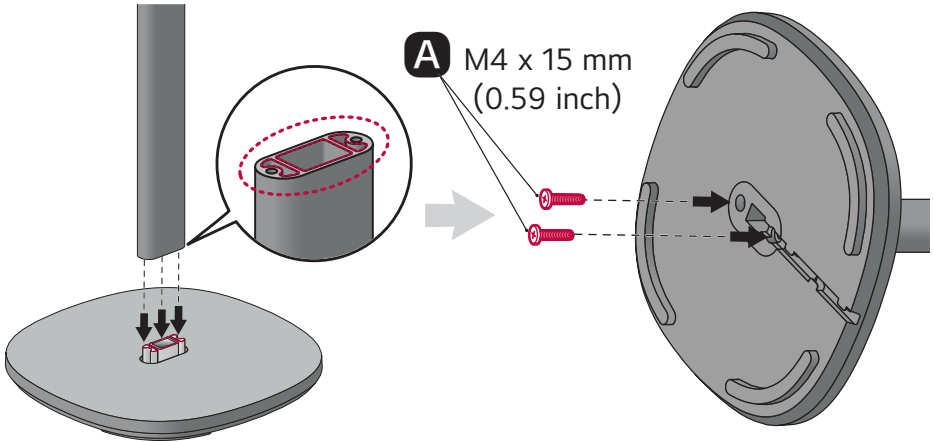

- 2 Insert the power cord through the opening on the bottom of the stand base and pass it out from the opposite side of the stand pole.

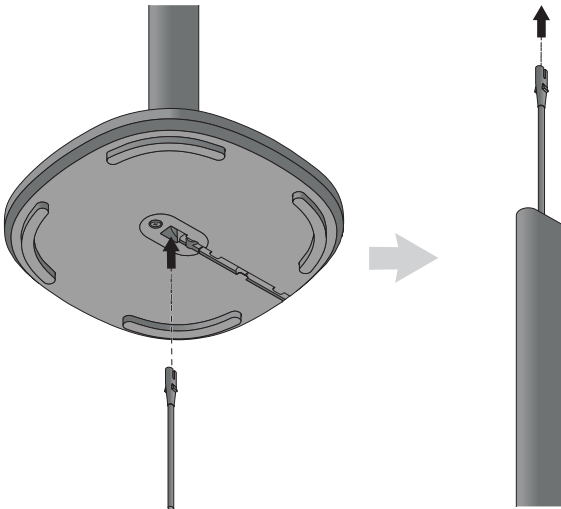

- 3** Insert the power cord through the center hole of the top plate as shown in the image. Align the protrusion of the top plate with the power cord groove on the bottom of the stand base and attach the top plate to the stand pole. Then, firmly secure the connection using two screws **A** (M4 x 15 mm (0.59 inch)).

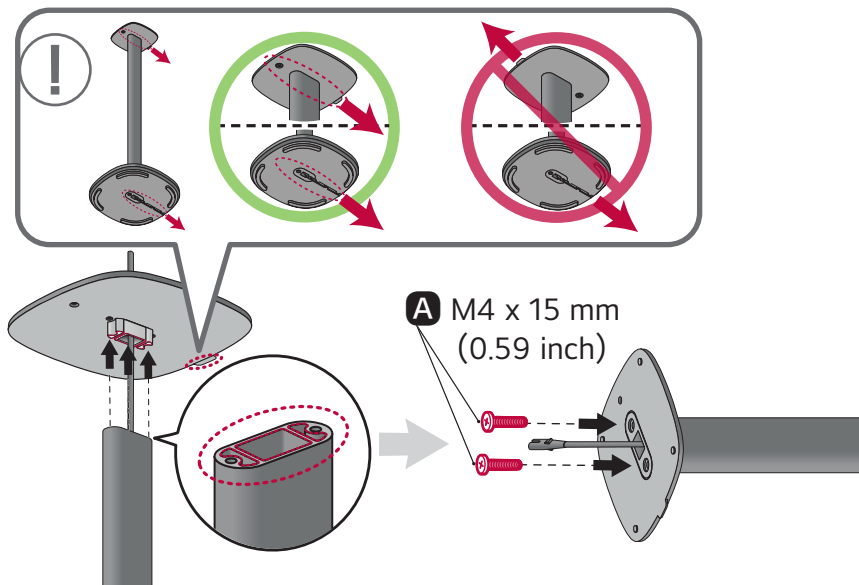

- 4** Plug the power cable into the **AC IN** port on the bottom of the product.

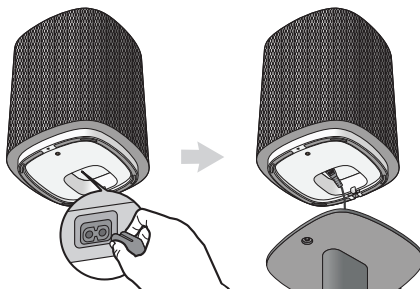

- 5** Place the speaker on the top plate and insert the marked protrusion of the top plate into the groove of the speaker as shown in the image. Then, firmly secure the speaker to the top plate using the screw **B** (M4 x 8 mm (0.31 inch)).

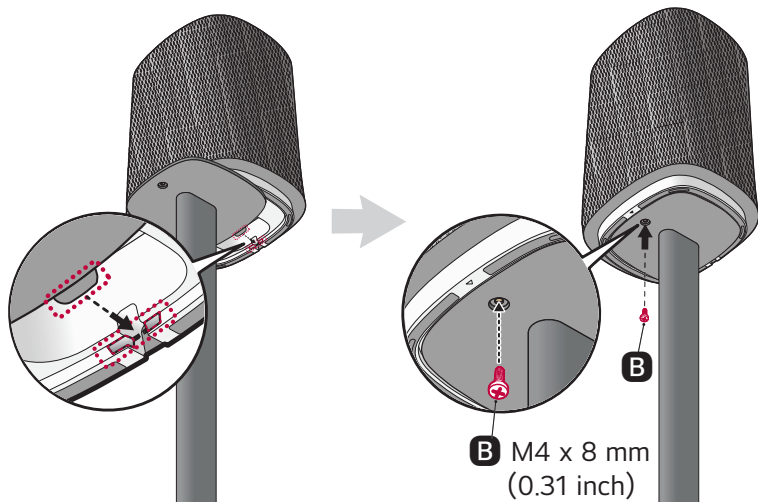

- 6** Route the power cable along the groove on the bottom of the stand base.

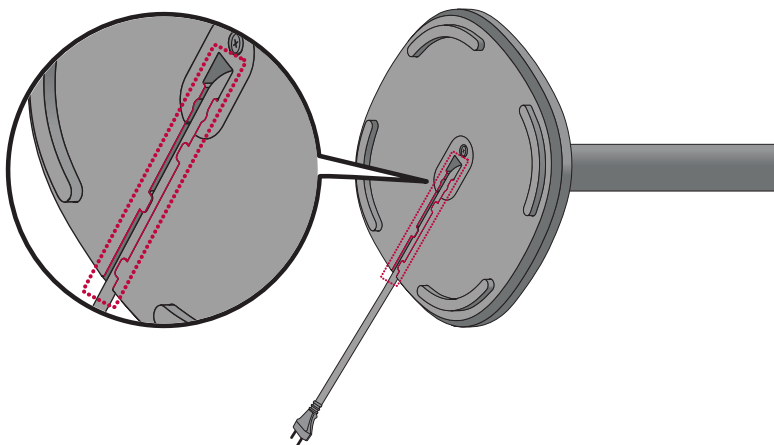

# Connecting

## | Connecting with the product via LG ThinQ app

**LG ThinQ app** allows you to connect the product to the network and to control the product.

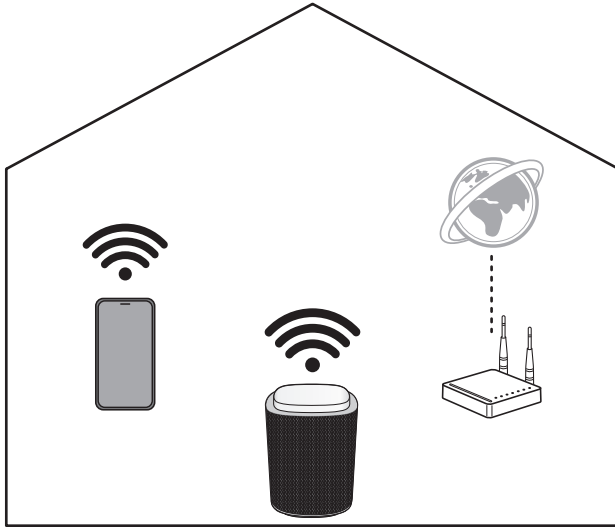

### Please check the following first.

- Do you have a wireless router?
  - To connect your smartphone and the product via Wi-Fi, you must have a wireless router that is connected to the internet.
  - Make sure that they are both connected to the same Wi-Fi network.
  - If the wireless router signal is weak, it may not be able to connect. Move the router closer to the product or reposition it away from obstacles.
- Does your smartphone have **Bluetooth** enabled?
  - Enable **Bluetooth** on your smartphone.
  - If **Bluetooth** is enabled, you can easily connect to Wi-Fi. If **Bluetooth** is disabled, the product may not be registered on the **LG ThinQ app**.
- The **LG ThinQ app** is available in the versions listed below.
  - Android™ OS: Version 9.0 or higher
  - iOS OS: Version 16.0 or higher
  - Minimum supported versions for each OS may change later.

## Installing the LG ThinQ app and registering the product

---

- ➊ Go to the Google Play or the App Store on your smartphone and search for the **LG ThinQ app** to install it.
- ➋ Run the **LG ThinQ app** and log in to the app with your account. If you don't have an account, you can also create a new one.
- ➌ Press the **add (+)** button and follow the on-screen instructions in the **LG ThinQ app** to register your **Sound Suite** products.

---

### ✔ Note

- Settings menu items may vary depending on the smartphone manufacturer and OS.
  - Google, Android, Google Play, Google Home and Google Cast are trademarks of Google LLC.
  - If the router password contains some special characters (such as ` ' " + / \ ; : - \_ ^ & () <>) or emoticons, the product may not be connected. It is recommended to set a password using a combination of English letters and numbers.
  - It is recommended to set the security type of the wireless router to WPA2.
-

# Connecting via Bluetooth

You can play music files stored on a **Bluetooth** device, or run music apps to enjoy the music with this product.

## Please check the following first.

Steps to connect the device to the product may vary depending on the **Bluetooth** device type and model. For more information on how to connect the device, refer to your external device's user manual.

Select the [**Bluetooth**] from your smartphone's **Settings** menu. Settings menu items may vary depending on your smartphone manufacturer and model.

- 1 Turn on the product.
- 2 Press the **Source** (📶) button repeatedly on the product until the lighting indicator lights up blue to select the **Bluetooth** mode. After a moment, the lighting indicator blinks blue. If the lighting indicator does not blink blue, press and hold the **Source** (📶) button for more than 2 seconds while in **Bluetooth** mode. **Bluetooth** scanning and connection are available for 1 minute via your smartphone.



- 3 Tap the **Settings** (⚙️ / ⚙️) button on your smartphone and select **Bluetooth**.
- 4 Turn on the **Bluetooth** function. (🔌 Off > 🔌 On)
- 5 You will see a list of connectable devices on your smartphone. Find and select "LG Sound Suite Series model name".



- 6 When the product is connected to the smartphone via **Bluetooth**, the lighting indicator lights up blue.
- 7 If you cannot find the product "LG Sound Suite Series model name", turn the **Bluetooth** off and turn it on again on your smartphone.
- 8 Run a Music app and listen to music on the smartphone.

---

✔ **Note**

- The closer the **Bluetooth** device is to the product, the better your connection.
  - If the product is not connected to a **Bluetooth** device, the center of the lighting indicator lights up blue. Check the status of the **Bluetooth** device.
  - If the product does not appear in your smartphone's **Bluetooth** search, press and hold the **Source**  button on the product for more than 2 seconds while in **Bluetooth** mode.
  - When using **Bluetooth**, you should adjust the volume level to an appropriate level.
-

## Connecting via a USB 2.0 Cable

### Please check the following first.

- This product can be used with gaming PCs, laptops or game console\* that support UAC\*\* (USB Audio Class).
  - PCs, laptops: with UAC 2.0
  - Game console (PlayStation 4/5): UAC 1.0 support
- \* If there is no audio output when the speaker and device (PS4/PS5/PC, etc.) are connected with a USB cable, turn off the UAC 2.0 option in the **LG ThinQ app**. To apply the configured settings, press and hold the **Power** (⏻) button for more than 3 seconds to turn off the product, then power it on again.
- \*\* UAC (USB Audio Class): Digital audio connection standard that used a USB interface and distinction between 1.0 and 2.0 by the transmission speed and data size that it supports.
- It may not work properly depending on the specifications of device that support UAC (USB Audio Class) For more information, contact your device manufacturer.
- The speaker's PC specifications are as follows:
  - Windows OS: 10 version 20H2
  - MAC OS: 11.2 version
  - It is recommended to use the speaker with this version or later.
- Connecting a monitor or some smartphone to the speaker via USB C to USB C cable may result in no sound.

- 1 Press the **Source**  button repeatedly on the product until the lighting indicator lights up amber to select USB-Audio mode. After a moment, the lighting indicator blinks amber.



- 2 Connect the product to your PC using a USB 2.0 cable.

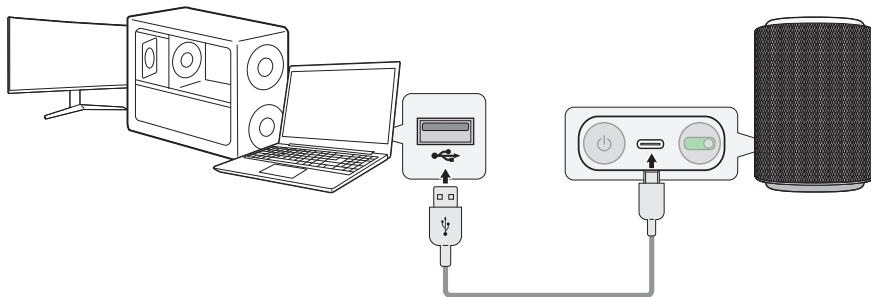

- 3 When the product is connected to the playback device, the lighting indicator lights up amber briefly and then switches to the ambient lighting color set through the **LG ThinQ app**.
- 4 Switch the audio output on your PC to USB Audio.
- 5 Select a music app on your PC and start playback.

#### ✔ Note

- If you do not have the USB 2.0 cable, purchase it separately.
- When using the USB-Audio mode, it is recommended to use a USB-IF certified cable of 1.2 m (3.9 ft) or less that supports USB 2.0 High-Speed.
- Using a USB 2.0 cable that is either non-certified or longer than 1.2 m (3.9 ft) may result in reduced operational stability.

# Connecting to a USB Storage Device

Enjoy high-quality sound by connecting a USB storage device containing music files to the product.



## Connecting the product to a USB storage device

- 1 Press the **Source**  button repeatedly on the product until the lighting indicator lights up amber to select USB Drive mode. After a moment, the lighting indicator blinks amber.

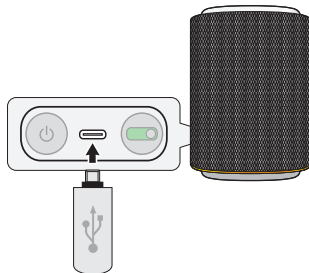

- 2 Plug the USB storage device into the **USB** port on the back of the product.
  - If the USB storage device does not have a USB-C port, a USB-C adapter is required.
  - The product cannot play any devices connected via a USB storage device hub or a USB storage device cable.
  - The product is designed to support only standard USB flash drives. It cannot be connected to any USB storage device, USB type MP3 player, external HDD, or card reader that requires a separate device driver to be installed.



- 3 When the product is connected to the USB storage device, the lighting indicator lights up amber briefly and then switches to the ambient lighting color set through the **LG ThinQ app**. Afterward, the music plays automatically.
  - Play/Pause: Press the **Play/Pause**  button.
  - Moving to the next music: Press the **Play/Pause**  button twice quickly.
  - Moving to the previous music: Press the **Play/Pause**  button three times quickly.

✔ **Note**

- It is recommended that you purchase a separate extension cable to make it easier to plug in and out USB storage devices.
- USB devices with a large storage volume may take several minutes to browse through files.
- LG Electronics is not responsible for any data loss. Please always back up the data on your USB storage device to minimize damage caused by data loss.
- Only FAT16/FAT32/NTFS formats are supported. exFAT format is not supported.
- Use the USB port of this product only for playing a media file. You cannot charge external devices with the USB port.

## USB storage devices supported

- USB flash device

This product may not recognize some USB storage devices.

## Playable file specifications

File extension	Sampling frequency / Bitrate
MP3	32 kHz - 48 kHz / 8 kbps - 320 kbps
AAC	32 kHz - 48 kHz / 8 kbps - 320 kbps
OGG	32 kHz - 48 kHz / 64 kbps - 320 kbps

File extension	Sampling frequency
FLAC (16 bit/24 bit)	32 kHz, 44.1 kHz, 48 kHz, 88.2 kHz, 96 kHz, 176.4 kHz, 192 kHz
WAV (16 bit/24 bit)	32 kHz, 44.1 kHz, 48 kHz, 88.2 kHz, 96 kHz, 176.4 kHz, 192 kHz

- Number of playable files: Up to 2,000
- Maximum number of directories: Up to 200
- This product cannot play files protected by DRM (Digital Rights Management).
- This product cannot play video files from a USB storage device.

# Connecting Stereo Speakers

You can connect stereo speakers using the speaker connecting feature.

## Stereo mode

Stereo mode lets you enjoy stereo sound with the same two speakers.

### Please check the following first.

- The same two speakers are needed. (E.g. Two M7 units or two M5 units)
- Install the **LG ThinQ app** on your smartphone and follow the on-screen instructions to register the product. (→ See "Connecting with the product via LG ThinQ app")

- 1 Select [Stereo Mode] in the **LG ThinQ app**.
- 2 Select [Stereo Mode] and connect the remaining speakers in sequence.

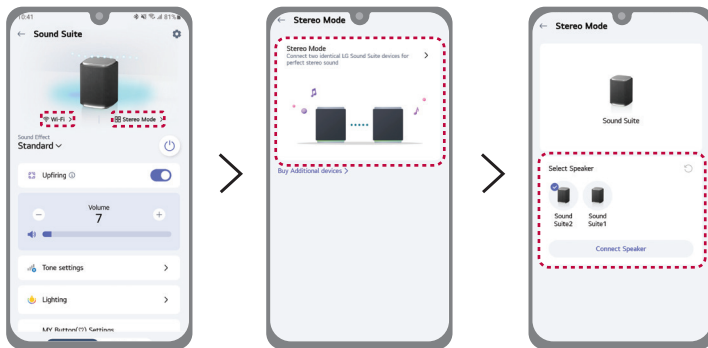

**3** You can see the lighting Indicator on the speakers.

- Main speaker: The left side of the lighting Indicator lights up white, the backlight of the **Source**  button lights up white, and the speaker outputs the Left channel sound.
- Other speaker: The right side of the lighting Indicator lights up white, and the speaker outputs the Right channel sound.

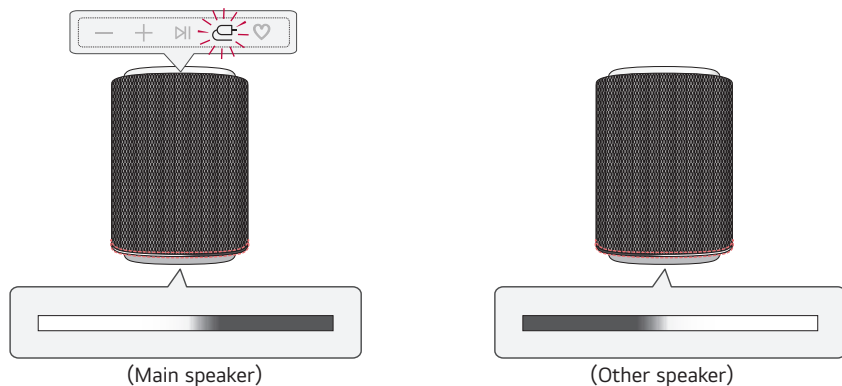

---

**Note**

- When using Stereo mode, you can change the speaker's left and right channel positions via the **LG ThinQ app**.
  - If you change to Dolby Atmos FLEXCONNECT mode during Stereo mode connection, Stereo mode will be disconnected automatically.
  - You can disconnect Stereo mode by using the **LG ThinQ app** or by resetting the product. Stereo mode cannot be disconnected by turning the power off and on, or by unplugging and reconnecting the power cord. Even if you turn the power off and on again while in Stereo mode, the product will automatically reconnect to the same mode.
  - Depending on the network environment, this function may not work well.
  - When using Stereo mode, the functions and status of the other speakers are synchronized with the main speaker. (Volume, Audio cues, Auto Power Management, Sleep Timer, Ambient lighting, Standby Mode lighting)
-

# Playback

## Compatible with Google Assistant

### Please check the following first.

- Be aware that some features, specifications, applications, services and/or content (“Features”) may not be available in some countries. The Features may vary by country and are subject to change without notice. The Features may not be available in some languages. Refer to lg.com for service status by country.
- When connected via Dolby Atmos FLEXCONNECT or set to 'Other' product in Stereo mode, the product may not be discoverable when using Google Cast, AirPlay, Spotify, or Tidal.

Control your device using just your voice with help from Google Assistant.

If you have a compatible Google Assistant-enabled device with Google Cast, you can add this device in your Google Home app. You will be able to play, skip, or stop music, and change the volume - just ask Google Assistant.

### Requirements

- Google Assistant-enabled device (Sold Separately)
- This product must be connected to the Internet.
- This product must be set up in the **Google Home** app.



## Using Google Cast™

You can listen to your favorite music on this product using hundreds of Google Cast-enabled apps on your phone, tablet or laptop.



Simply tap the **Cast** button from apps you already know and love. No new logins or downloads required. Use your phone to search, play, pause and turn up the volume from anywhere in the home.

For more information on Google Cast, including a list of Google Cast-enabled apps you can cast from, visit [g.co/cast/audio](https://g.co/cast/audio)

To set up multiroom with other Google Cast-enabled speakers, download the **Google Home** app.

## Works with Apple AirPlay

### Please check the following first.

- Be aware that some features, specifications, applications, services and/or content (“Features”) may not be available in some countries. The Features may vary by country and are subject to change without notice. The Features may not be available in some languages. Refer to lg.com for service status by country.
- When connected via Dolby Atmos FLEXCONNECT or set to ‘Other’ product in Stereo mode, the product may not be discoverable when using Google Cast, AirPlay, Spotify, or Tidal.

This product allows you to listen to the music from your iOS device through AirPlay.

### ✔ Note

- Make sure that this product and your iOS device are connected to the same Wi-Fi network.
- Make sure that your iOS device is running iOS 11.4 or later.
- The AirPlay 2-Enabled Speakers are needed to stream to multiple speakers.

### Stream music through AirPlay

- 1 Open a music player app or the Control Center on your iOS device.
- 2 Tap AirPlay (📶).
- 3 Choose your product to listen to music. You can choose one or more AirPlay 2-enabled speakers.



Apple®, AirPlay®, iPad®, iPad Air®, iPad Pro® and iPhone® are trademarks of Apple Inc., registered in the U.S. and other countries.

Use of the Works with Apple badge means that an accessory has been designed to work specifically with the technology identified in the badge and has been certified by the developer to meet Apple performance standards.

To control this AirPlay 2-enabled speaker, iOS 11.4 or later is required.

# Spotify Connect

## Please check the following first.

- Be aware that some features, specifications, applications, services and/or content ("Features") may not be available in some countries. The Features may vary by country and are subject to change without notice. The Features may not be available in some languages. Refer to lg.com for service status by country.
- When connected via Dolby Atmos FLEXCONNECT or set to 'Other' product in Stereo mode, the product may not be discoverable when using Google Cast, AirPlay, Spotify, or Tidal.

Use your phone, tablet or computer as a remote control for Spotify. Go to [spotify.com/connect](https://spotify.com/connect) to learn how.



The Spotify Software is subject to third party licenses found here: <https://www.spotify.com/connect/third-party-licenses>.

## | Tidal Connect

### **Please check the following first.**

- Be aware that some features, specifications, applications, services and/or content ("Features") may not be available in some countries. The Features may vary by country and are subject to change without notice. The Features may not be available in some languages. Refer to lg.com for service status by country.
- When connected via Dolby Atmos FLEXCONNECT or set to 'Other' product in Stereo mode, the product may not be discoverable when using Google Cast, AirPlay, Spotify, or Tidal.

Use your phone, tablet or computer as a remote control for Tidal. Go to [tidal.com/connect](https://tidal.com/connect) to learn how.



# LG radio+

## Please check the following first.

- Be aware that some features, specifications, applications, services and/or content (“Features”) may not be available in some countries. The Features may vary by country and are subject to change without notice. The Features may not be available in some languages. Refer to lg.com for service status by country.
- When connected via Dolby Atmos FLEXCONNECT or set to ‘Other’ product in Stereo mode, the product may not be discoverable when using Google Cast, AirPlay, Spotify, or Tidal.

You can listen to the radio and podcast via **LG ThinQ app**.

Use LG Radio+ selecting [Contents] tab at the bottom of the **LG ThinQ app** screen.

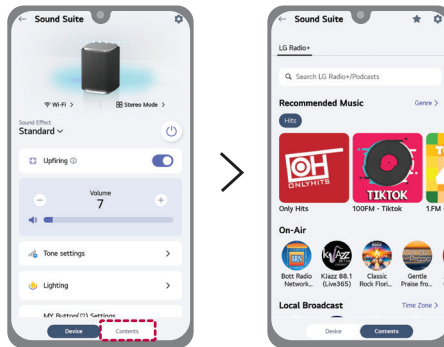

# Various settings for convenience

## | Using MY function

The **MY** function allows you to play your music quickly and easily.

- 1 Set your **MY** function in the **LG ThinQ app**. Follow the instructions to set a playlist, volume level.
- 2 Press the **MY**  button.



---

### ✔ Note

- To use the **MY** function, allow the media access permission.
  - The lighting indicator blinks white in the following cases:
    - The **MY** function is not set in the **LG ThinQ app**.
  - The **MY**  button may not function properly under the following conditions:
    - The device connected to the speaker is not connected to the network.
    - The music streaming service assigned to the **MY** function does not have an account.
    - Media access permissions have been disabled.
    - The **MY** function is not set in the **LG ThinQ app**.
-

# Using Room Calibration Pro

This technology allows you to analyze the sound coming from the product and fine-tune the audio settings. Note: when you start Room Calibration Pro, the product may make a louder sound than expected.

## Please check the following first.

- If the microphone is turned off, the Room Calibration Pro feature cannot be used. Slide the **MIC (Microphone)** switch on the rear of the product to the ON position. (OFF > ON)
- The microphone is used solely for audio functionality and does not collect the user's sound.

## Using Room Calibration Pro on the Product

- 1 Press the **MY**  button twice.
- 2 The lighting indicator on the product displays dynamic, multicolored light animations and Room Calibration Pro automatically begins.
- 3 After a moment, the lighting indicator on the product displays multicolored lighting, and Room Calibration Pro is completed.

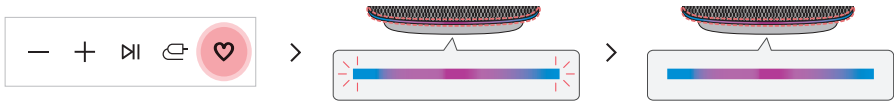

# Using Room Calibration Pro in the LG ThinQ app

- 1 Select the **Settings**  button on **LG ThinQ app**.
- 2 Select **[Room Calibration Pro]** → **[Start]** and follow the on-screen instructions in the **LG ThinQ app**.

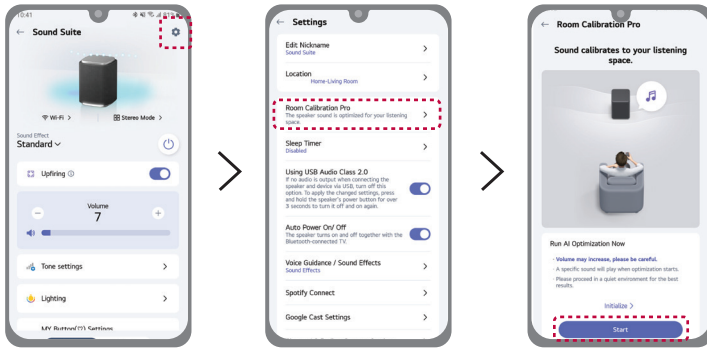

## ✓ Note

The Room Calibration Pro feature is not available while the Dolby Atmos FLEXCONNECT function is active.

# Using Sound Effects

## Using Upfiring

You can use the Upfiring feature in the **LG ThinQ app**.

The Upfiring is a technology that improves audio quality by adding virtual speaker channels.

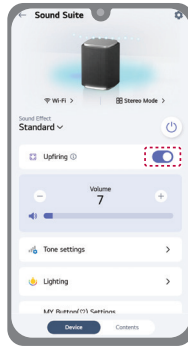

### ✔ Note

When the AI Sound Pro sound effect is in use, the Upfiring feature cannot be disabled.

# Using various Sound Effects

You can select various sound effects by using the in the **LG ThinQ app**.

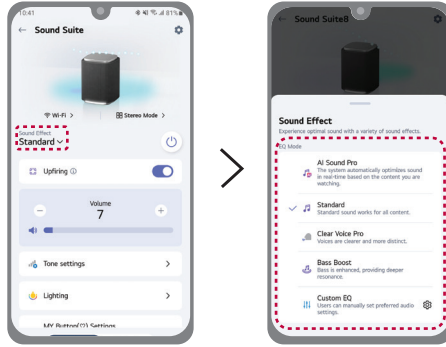

Sound effects	Description
AI Sound Pro	Artificial intelligence selects the optimal sound settings to suit your content.
Standard	You can enjoy optimized sound.
Clear Voice Pro	Improves the clarity of voices.
Bass Boost	Bass sounds are enhanced.
Custom EQ	You can customize the sound effect to suit your personal preference.

# Using Ambient lighting

Ambient lighting creates a more immersive atmosphere.

## Using Ambient lighting on the Product

You can press the **Volume** (–) and **MY** (♥) buttons on the product at the same time to turn the ambient lighting on or off. The color and brightness of the ambient lighting can be adjusted through the **LG ThinQ app**. Refer to the following information. (→ See “Using Ambient lighting in the LG ThinQ app”)



## Using Ambient lighting in the LG ThinQ app

You can turn the ambient lighting on or off using the **LG ThinQ app**. After turning on ambient lighting, set the desired color and brightness.

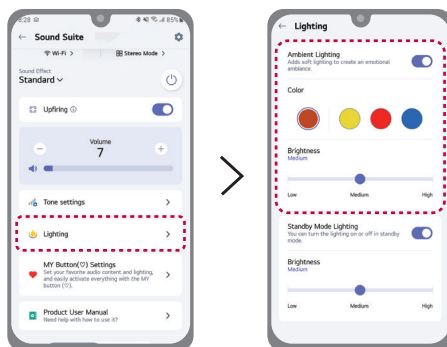

### ✓ Note

- The ambient lighting feature is available in all functions, regardless of music playback.
- The lighting indicator takes precedence over the ambient lighting.
- Do not look directly at the light-emitting part when the ambient lighting feature is turned on.
- If the illumination brightness is glaring, switch on the room lights or turn off the ambient lighting feature of the product.

## Using Standby Mode lighting

You can turn the standby mode lighting on or off and adjust its brightness using the **LG ThinQ app**.

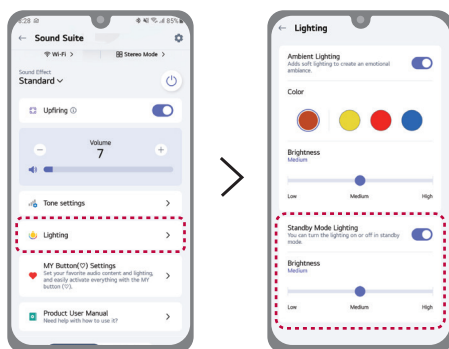

## Resetting the Product

If the network connection is unstable, you will need to reset it. If the Wi-Fi network has been changed, you will need to reset the product and connect it to your smartphone again.

### How to reset

- 1 Press and hold the **Power** (⏻) button on the product for more than 10 seconds until you hear a sound signal.
- 2 All button backlights blink four times, and all wireless network settings and volume configurations on the product will be cleared.

#### ✔ Note

Once you reset the product, you will also need to reconnect the product to the smartphone via Wi-Fi on the **LG ThinQ app**.

### How to deactivate the wireless network connection(s).

Press and hold the **Power** (⏻) button for 3 seconds or longer to turn off the product.

## Voice/Audio cues feedback function

When you select a function or sound, the current status of the product is guided by voice (English voice only) or audio cues.

You can switch to either voice or audio cues, or turn the function off using the **LG ThinQ app**.

---

### ✔ Note

- Voice/Audio cues feedback and product volume level to work together from 7 to 13. However the voice/audio cues feedback level cannot be adjusted below 7 or above 13.
  - During voice/audio cues feedback, all sounds except for voice/audio cues feedback becomes low temporarily.
-

# Using Dolby Atmos FLEXCONNECT

## | About Dolby Atmos FLEXCONNECT

### LG Sound Suite connection

---

This product can connect to other LG Sound Suite products to deliver optimal sound in any space or location. Without complicated wiring, you can enjoy optimal sound by connecting other LG Sound Suite products via the Dolby Atmos FLEXCONNECT settings in the **LG ThinQ app**.

### Dolby Atmos FLEXCONNECT

Dolby Atmos FLEXCONNECT is designed to pair a TV or soundbar system with wireless speakers, delivering a richer and more immersive Dolby Atmos sound experience. It uses built-in microphones on the TV or soundbar to detect the position of connected wireless speakers and optimizes the sound to match the room's layout and speaker configuration.

Connect up to 3 or 4 LG Sound Suite speakers and a subwoofer to a Dolby Atmos FLEXCONNECT compatible LG TV or soundbar to experience the ultimate Dolby Atmos sound. (→ See "Dolby Atmos FLEXCONNECT Connection Combinations")

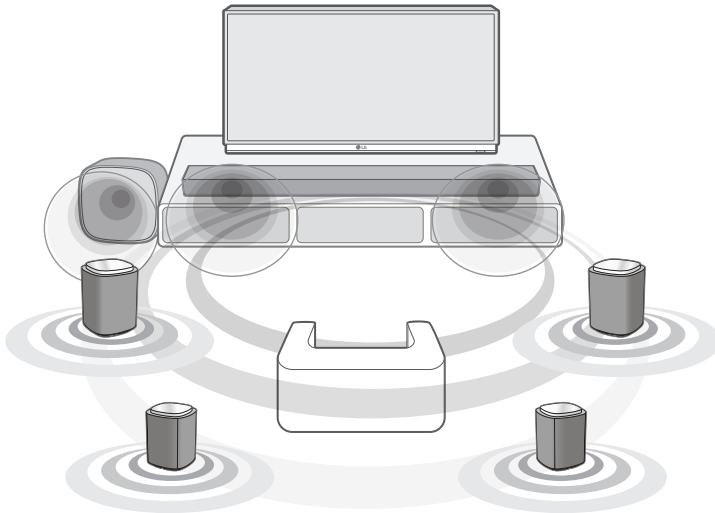

**Dolby Atmos**  
FLEXCONNECT

## LG Sound Suite products

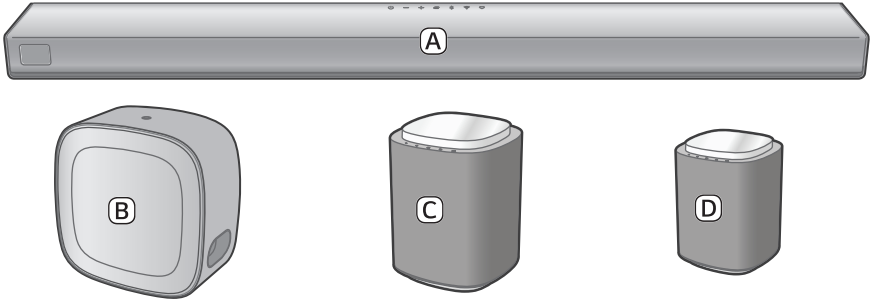

- 
- (A)** Soundbar (LG Sound Suite H7)
  - (B)** Subwoofer (LG Sound Suite W7)
  - (C)** Speaker (LG Sound Suite M7)
  - (D)** Speaker (LG Sound Suite M5)

---

**Note**

- LG Sound Suite products may be sold individually and may not contain all components shown. Some items may require separate purchase.
  - To enable the Dolby Atmos FLEXCONNECT connection, you must have the Dolby Atmos FLEXCONNECT-equipped LG TV or the LG Sound Suite soundbar, and meet one of the following conditions:
    - Use two or more M5 speakers. (Dolby Atmos FLEXCONNECT connection cannot be configured using a single M5 speaker.)
    - Use one or more M7 speakers.
    - Use one M5 speaker and one or more M7 speakers.
  - When setting up Dolby Atmos FLEXCONNECT with the H7 soundbar, use the HDMI cable to establish the e-ARC/ARC connection between the soundbar and the TV.
  - W7 requires an LG TV or soundbar with Dolby Atmos FLEXCONNECT support for connection.
    - After registering the soundbar in the **LG ThinQ app**, connect W7 through [Dolby Atmos FlexConnect] in the **LG ThinQ app**. (Refer to the W7 owner's manual for detailed connection instructions.)
  - W7 can be assigned to a Dolby Atmos FLEXCONNECT group, but does not operate in Dolby Atmos FLEXCONNECT mode.
  - A single W7 subwoofer can be connected to the TV or H7 soundbar via the Dolby Atmos FLEXCONNECT setting, but the Dolby Atmos FLEXCONNECT calibration function is not available.
  - The Dolby Atmos FLEXCONNECT calibration function does not automatically recognize the position of W7.
    - W7 position shown in the **LG ThinQ app** is for reference only and may differ from the actual installation location. This does not affect acoustic performance, so you can freely place it wherever you prefer.
  - Install the LG Sound Suite speakers and subwoofer at least 30 cm (11.8 inch) away from the TV or soundbar when connecting them.
  - To prevent wireless interference, maintain a distance of at least 1 m (3.3 ft) between the soundbar or the wireless subwoofer, wireless speakers and any peripheral devices that generate strong electromagnetic waves (ex. wireless routers, microwave ovens, etc.).
-

# Dolby Atmos FLEXCONNECT Setup with Soundbar

Set the Dolby Atmos FLEXCONNECT by connecting your LG Sound Suite products in the **LG ThinQ app**.

## Please check the following first.

- To set the Dolby Atmos FLEXCONNECT function, you need LG Sound Suite products.
- Dolby Atmos FLEXCONNECT-equipped products from other manufacturers are not compatible with LG Sound Suite products.
- Install and run the **LG ThinQ app** on your smartphone, then register your LG Sound Suite products.
- If the microphone on the soundbar is turned off, the Dolby Atmos FLEXCONNECT calibration feature cannot be used. Slide the **MIC (Microphone)** switch on the rear of the soundbar to the ON position. (OFF ON)
- The microphone is used solely for audio functionality and does not collect the user's sound.

- 1 Turn on all the LG Sound Suite products you want to use with the Dolby Atmos FLEXCONNECT feature.
- 2 In the **LG ThinQ app**, select the **Dolby Atmos FLEXCONNECT** feature.
- 3 Select [Edit Group].
- 4 A list of products that support Dolby Atmos FLEXCONNECT will appear. Select the product you want to connect and then select [Save].

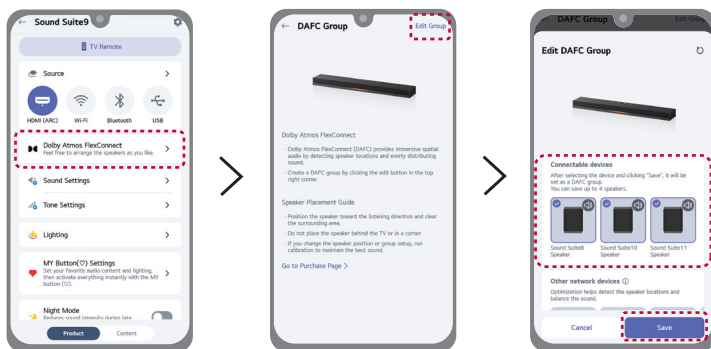

- 5 Set the distance between the LG Sound Suite soundbar and your listening position, then select [Next] and follow the instructions in the **LG ThinQ app**.

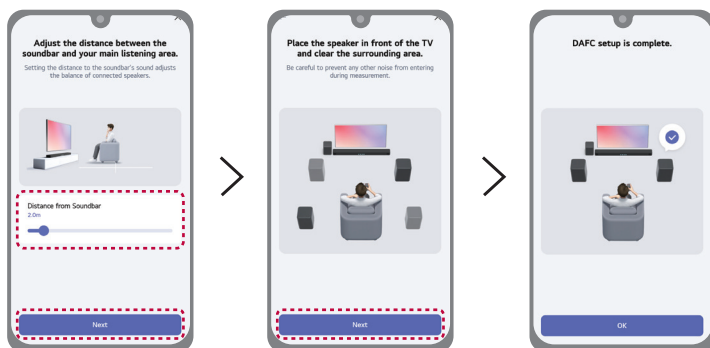

- 6 When the Dolby Atmos FLEXCONNECT connection is completed, the lighting indicator lights up white.

✓ **Note**

- For LG Sound Suite Speaker, only the **Power** (⏻) and **Source** (📺) buttons are available while using the Dolby Atmos FLEXCONNECT feature.
- When using the Dolby Atmos FLEXCONNECT feature, adjust the volume of your TV or soundbar as needed.
- When the speaker's Dolby Atmos FLEXCONNECT connection is unstable, the center of the lighting indicator lights up white. Check the Dolby Atmos FLEXCONNECT connection status.

# Configuring Dolby Atmos FLEXCONNECT Group (Soundbar)

Run the **LG ThinQ app** on your smartphone. Select the image with the speaker layout, then select the [Edit Group]. Check or uncheck a product to group or ungroup it in the Dolby Atmos FLEXCONNECT settings, following the instructions in the **LG ThinQ app**.

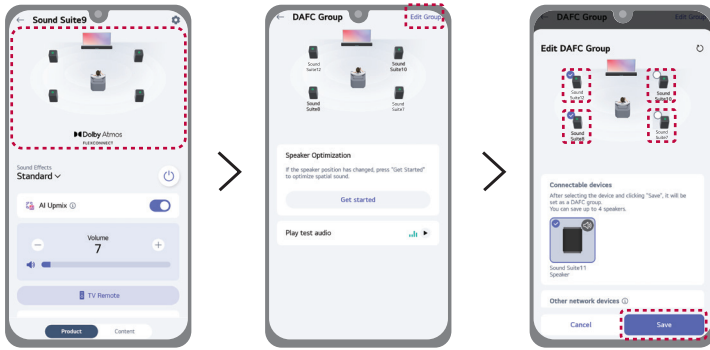

# Reset Dolby Atmos FLEXCONNECT calibration (Soundbar)

When changing the speaker's position, reset the Dolby Atmos FLEXCONNECT calibration to ensure optimal sound performance.

Select the image with the speaker layout, then select the [Get started] in [Speaker Optimization] and follow the instructions in the **LG ThinQ app**.

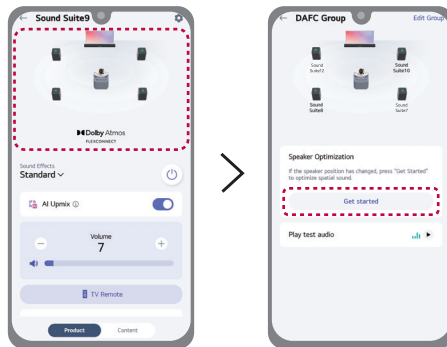

# Dolby Atmos FLEXCONNECT Setup with LG TV

Set the Dolby Atmos FLEXCONNECT by connecting your LG Sound Suite products and Dolby Atmos FLEXCONNECT-equipped LG TV.

## Please check the following first.

- To set the Dolby Atmos FLEXCONNECT function, you need LG Sound Suite products.
- Dolby Atmos FLEXCONNECT-equipped products from other manufacturers are not compatible with LG Sound Suite products.
- If the microphone on your TV is turned off, the Dolby Atmos FLEXCONNECT calibration feature cannot be used. Make sure the microphone on your TV is turning on by referring to TV's owner's manual.
- The microphone is used solely for audio functionality and does not collect the user's sound.
- Refer to your TV's user manual for detailed connection instructions.

**1** Turn on all LG Sound Suite products and TV you want to use with the Dolby Atmos FLEXCONNECT feature.

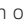
**2** LG Sound Suite Speaker: Press the **Source**  button repeatedly on the product until the lighting indicator lights up white to select the **Dolby Atmos FLEXCONNECT** mode. After a moment, the lighting indicator will blink white for 30 minutes. If the lighting indicator does not blink white, press and hold the **Source**  button on the product for more than 2 seconds.

LG Sound Suite Subwoofer: Check whether the lighting indicator blinks white. If the lighting indicator does not blink white, briefly press the **Button**  on the product, and the lighting indicator will blink white for 30 minutes.



(LG Sound Suite Speaker)



(LG Sound Suite Subwoofer)

- 
- 3** From the Settings menu on your TV, go to [Sound settings] and select [Sound output].
- 4** Select [Use External Speaker with TV Speaker].
- 5** A list of available external speakers will appear on the TV screen. Find and select [Dolby Atmos FlexConnect], then follow the instructions on the TV screen.

---

✔ **Note**

- For LG Sound Suite Speaker, only the **Power** (⏻) and **Source** (📺) buttons are available while using the Dolby Atmos FLEXCONNECT feature.
  - When using the Dolby Atmos FLEXCONNECT feature, adjust the volume of your TV as needed.
  - If the speaker's Dolby Atmos FLEXCONNECT connection is unstable, the following will be displayed. Check the Dolby Atmos FLEXCONNECT connection status.
    - LG Sound Suite Speaker: The center of the lighting indicator lights up white.
    - LG Sound Suite Subwoofer: The lighting indicator blinks white.
  - If the product is not detected by the TV, do the following.
    - LG Sound Suite Speaker: Press and hold the **Source** (📺) button on the product for more than 2 seconds in Dolby Atmos FLEXCONNECT mode.
    - LG Sound Suite Subwoofer: Press the **Button** (⏻) briefly on the product.
-

# Dolby Atmos FLEXCONNECT Connection Combinations

## Combinations with Soundbar

---

### 1 speaker with/without subwoofer

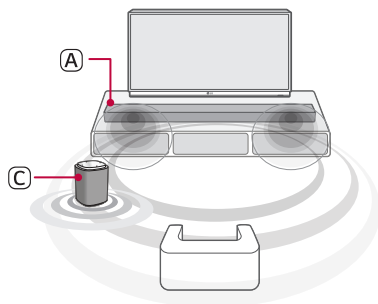
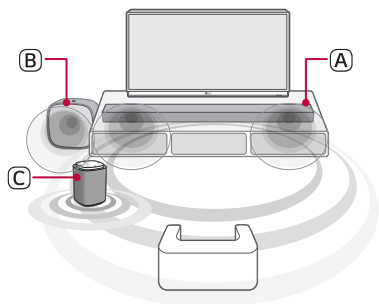

- (A) Soundbar (LG Sound Suite H7)
- (B) Subwoofer (LG Sound Suite W7)
- (C) Speaker (LG Sound Suite M7)

### 2 speakers with/without subwoofer

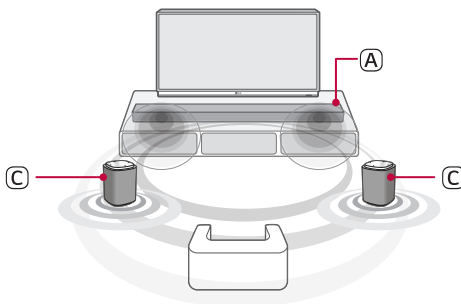
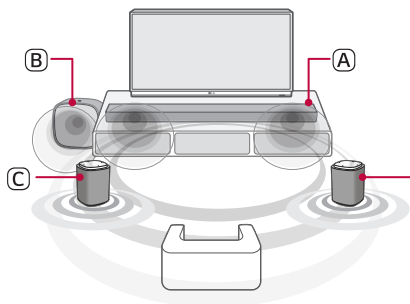

- (A) Soundbar (LG Sound Suite H7)
- (B) Subwoofer (LG Sound Suite W7)
- (C) Speakers (LG Sound Suite M7 or M5)

### 3 speakers with/without subwoofer

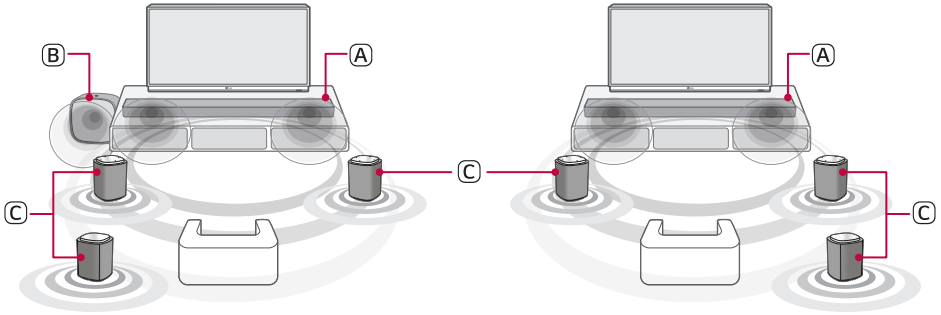

- (A) Soundbar (LG Sound Suite H7)
- (B) Subwoofer (LG Sound Suite W7)
- (C) Speakers (LG Sound Suite M7 or M5)

### 4 speakers with/without subwoofer

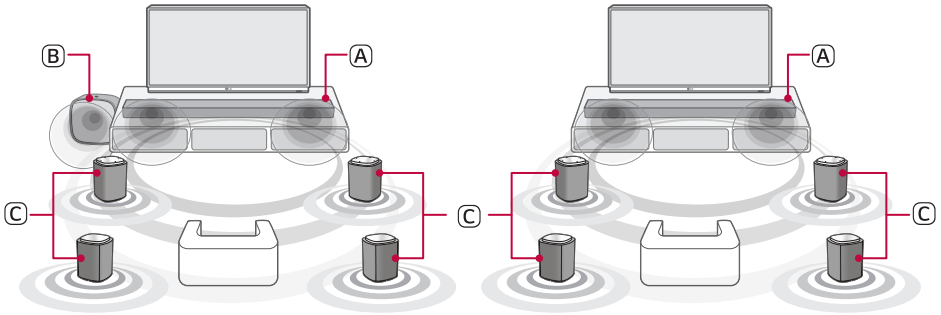

- (A) Soundbar (LG Sound Suite H7)
- (B) Subwoofer (LG Sound Suite W7)
- (C) Speakers (LG Sound Suite M7 or M5)

# Combination with TV

---

## 1 speaker with/without subwoofer

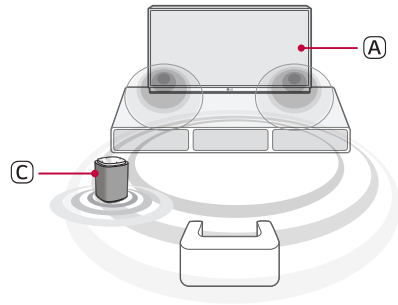
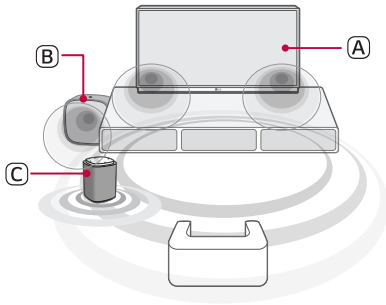

- (A) Dolby Atmos FLEXCONNECT-equipped LG TV
- (B) Subwoofer (LG Sound Suite W7)
- (C) Speaker (LG Sound Suite M7)

## 2 speakers with/without subwoofer

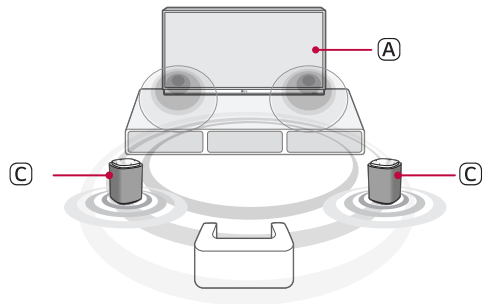
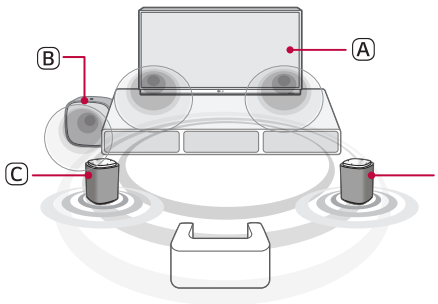

- (A) Dolby Atmos FLEXCONNECT-equipped LG TV
- (B) Subwoofer (LG Sound Suite W7)
- (C) Speakers (LG Sound Suite M7 or M5)

### 3 speakers with/without subwoofer

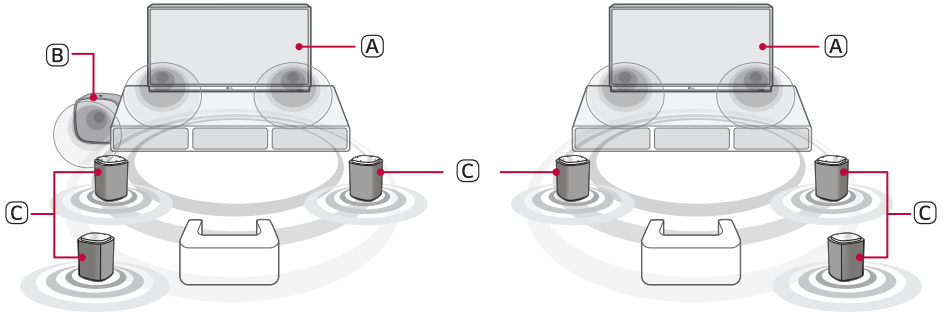

- (A) Dolby Atmos FLEXCONNECT-equipped LG TV
- (B) Subwoofer (LG Sound Suite W7)
- (C) Speakers (LG Sound Suite M7 or M5)

### 4 speakers

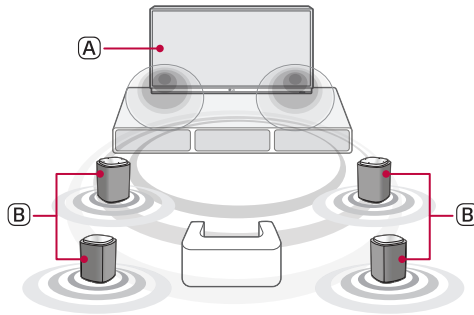

- (A) Dolby Atmos FLEXCONNECT-equipped LG TV
- (B) Speakers (LG Sound Suite M7 or M5)

# Safety Precautions

## | Safety and Regulatory



**CAUTION:** TO REDUCE THE RISK OF ELECTRIC SHOCK DO NOT REMOVE COVER (OR BACK). NO USER-SERVICEABLE PARTS INSIDE. REFER SERVICING TO QUALIFIED SERVICE PERSONNEL.



This lightning flash with arrowhead symbol within an equilateral triangle is intended to alert the user to the presence of uninsulated dangerous voltage within the product's enclosure that may be of sufficient magnitude to constitute a risk of electric shock to persons.



The exclamation point within an equilateral triangle is intended to alert the user to the presence of important operating and maintenance (servicing) instructions in the literature accompanying the product.

### **WARNING:**

- To prevent fire or electric shock hazard, do not expose this product to rain or moisture.
- Do not install this equipment in a confined space such as a book case or similar unit.
- This unit contains magnets which can be harmful to certain kinds of objects (Ex: Magnetic card, Pacemaker etc..).

### **CAUTION:**

- Do not block any ventilation openings. Install in accordance with the manufacturer's instructions. Slots and openings in the cabinet are provided for ventilation and to ensure reliable operation of the product and to protect it from over heating. The openings should never be blocked by placing the product on a bed, sofa, rug or other similar surface. This product shall not be placed in a built-in installation such as a bookcase or rack unless proper ventilation is provided or the manufacturer's instruction has been adhered to.
- The apparatus should not be exposed to water (dripping or splashing) and no objects filled with liquids, such as vases, should be placed on the apparatus.
- No naked flame sources, such as lighted candles, should be placed on the apparatus.
- To avoid fire or electric shock, do not open the unit. Contact to qualified personnel only.
- Do not leave the unit in a place near the heating appliances or subject to direct sunlight, moisture, or mechanical shock.
- Do not leave the unit on an unstable place such as high shelves. It may fall down because of the vibration of the sound.
- Do not use high voltage products around this product. (ex. Electrical swatter) This product may malfunction due to electrical shock.

- For safety marking information including product identification and supply ratings, please refer to the main label on the bottom or the other surface of the product.
- Be careful to make sure children do not put their hands or any objects into the \*speaker duct.
  - \* speaker duct: A hole for plentiful bass sound on speaker cabinet. (enclosure)

**CAUTION concerning the Power Cord**

Install this apparatus in a location where the power plug can be easily unplugged and plugged in. If there is a fire or problem with this apparatus, unplug it quickly.

Check the specification page of this owner’s manual to be certain of the current requirements.

Do not overload wall outlets. Overloaded wall outlets, loose or damaged wall outlets, extension cords, frayed power cords, or damaged or cracked wire insulation are dangerous. Any of these conditions could result in electric shock or fire. Periodically examine the cord of your device, and if its appearance indicates damage or deterioration, unplug it, discontinue use of the device, and have the cord replaced with an exact replacement part by an authorized service center.

Protect the power cord from physical or mechanical abuse, such as being twisted, kinked, pinched, closed in a door, or walked upon. Pay particular attention to plugs, wall outlets, and the point where the cord exits the device.

**Symbols**

~ : Alternating current (AC).

— : Direct current (DC).

Ⓜ : This is a class II equipment.

⏻ : Standby power state.

⏻ : The power is turned on.

⚡ : Danger voltage.

# Prevention of product misuse

To prevent misuse of the product, please be sure to check the contents below.

## Precautions for installing the product

---

- Do not install the product in an unstable or vibrating place, such as on a shaking shelf or inclined surface. Install the product on a firm and level surface.
  - Otherwise, the product may fall or tip over and cause injury.
  - If you install the product on an unstable surface, the product may not work properly.
- If you install the product on a piece of furniture or shelf, make sure that the bottom front of the product does not protrude. Always use a piece of furniture or shelf that fits the product size.
  - Otherwise, the product may lose its balance and fall, causing injury or product damage.
- Install the product in a safe place. Otherwise, a child may bump into an edge of the product and get injured.
- Install the product in a place free from electromagnetic interference for proper operation.
- If you install the product in a place that does not meet the general use conditions, an unexpected quality problem may arise. So, make sure that you contact the service center first before installing the product in such a place.
- Do not keep the product in a place where the temperature is too high (above 40 °C (104 °F)) or too low (below 5 °C (41 °F)) or a place with too much humidity.
- Avoid places exposed to direct sunlight or heat, e.g., near a heater. Do not use or keep flammable sprays or substances near the product.
  - Otherwise, there is a risk of explosion or fire.
- Do not install the product in a place with too much moisture, dust or soot.
  - Otherwise, it may cause a fire or electric shock.
- Do not install the product in a narrow space, such as inside a bookshelf, that does not ventilate well. Do not cover the product with a table cover or curtain.
  - Otherwise, it may increase the product temperature, causing a breakdown or fire.
- Connect the power plug of the product to a power outlet that is easily accessible.
  - When a fire or other problem occurs in the product, you must be able to remove the power plug quickly.
- Do not connect multiple products to one power outlet at the same time.
  - Otherwise, it may cause overheating, resulting in a fire.

## Precautions for using the product

---

- Do not lift or move the product while it is operating.
  - Otherwise, it may cause a breakdown.
- When moving the product, pull out the power cord and all cables connected to the product.
  - Otherwise, it may cause a fire or electric shock.
- Stop using the product immediately if you notice smoke or a strange odor. In this case, turn off the power immediately, disconnect the power plug, and contact the service center.
  - Using the product in this state may result in a fire or electric shock.
- Do not insert metal objects such as coins and hairpins or flammable objects such as paper and matchsticks into the product. Make sure that you tell any children not to do so.
  - Otherwise, it may cause a breakdown.
- If a foreign substance is inserted into the product, disconnect the power plug and contact the service center.
- Do not put a heavy object on top of the product.
  - Otherwise, it may tip over or fall, causing injury.
- Make sure that a child does not hang on the product or get on it.
  - Otherwise, the product may tip over or fall, causing injury. Make sure that you tell any children not to do so.
- Remove the power plug during thunderstorms.
  - Otherwise, it may cause a fire.
- Do not place vessels with liquid, such as a vase, pot, cosmetics, or medicine, on top of the product.
  - Otherwise, it may result in a fire, electric shock, or injury due to its fall, etc.
- Make sure that you connect the power plug firmly. Do not use voltage other than the rated voltage indicated on the product.
  - An insecure connection may result in a fire.
- Do not insert a conductor, such as chopsticks, into the groove on the other side of the product while the power plug is connected to an outlet. Do not touch the power plug immediately after unplugging it from the outlet.
  - Otherwise, it may cause electric shock.
- Hold the power plug with dry hands.
  - Otherwise, it may cause electric shock.
- Do not move or push the product while holding a product cable such as a power cord.
  - The cable may get damaged and cause a breakdown or result in a fire or electric shock.
- When removing a cable plugged into the product, make sure that you hold the connector at the end of the cable. Do not hold the cable line.
  - Otherwise, it may result in an injury or the product may fall and cause a breakdown.
- Do not keep the product in a place exposed to heat, e.g., near a heater.
  - Otherwise, it may cause a fire or malfunction.
- Do not disassemble, repair, or modify the product.
  - Otherwise, it may cause a breakdown, resulting in a fire, electric shock, or injury.
- Keep plastic wraps out of reach of toddlers.
  - Otherwise, toddlers may choke on the plastic wraps.
- Do not drop an object on the product or make an impact on it. Keep the product away from places with severe vibrations or magnets.

- Do not damage, modify, bend, twist, or heat a power cord.
  - Otherwise, it can damage the power cord, resulting in a fire or electric shock.
- When you are not using the product for a prolonged period, such as when you are away from home, unplug the power cord from the power outlet.
  - If dust accumulates, it can cause heat, resulting in electric shock or fire due to a short circuit.
- Do not dispose of waste batteries together with regular waste. Dispose of them separately.
  - Otherwise, there is a risk of explosion or fire.
- Do not use high voltage products around this product. (ex. Electrical swatter)
  - This product may malfunction due to electrical shock.
- Do not touch the power plug immediately after unplugging it from the outlet.
  - Otherwise, it may cause electric shock.
- Connect the power plug to a grounded outlet or extension cord. (This does not apply to products without a ground.)
  - Otherwise, it may cause a breakdown or electric shock due to a short circuit.
- In the case of a product with a vent, keeping the product turned on for a prolonged period can result in the vent getting hot. Do not touch the vent when it is hot. The heat is not a fault of the product and does not cause any malfunction. So, you may use the product without worry.
- Do not damage the power cable, AC adapter, or power plug. Do not place a heavy object on top of the power cable or AC adapter.
  - Otherwise, it may cause a fire or electric shock.
- If dust, dirt, etc. is found on the power plug pins, an AC adapter, or a power outlet, wipe it completely.
  - Otherwise, it may cause a fire.
- In the case of a product with a power cord or AC adapter, use only genuine power cords and AC adapters provided by LG Electronics.
  - Otherwise, it may cause a fire or electric shock.
- If you are using headphones or earphones, do not turn on the volume too loudly or use them for a prolonged period. [This only applies to models that support headphones or earphones]
  - Otherwise, it may negatively affect your hearing ability.
- The software of this product can be updated. Do not turn off the power of the product while updating the software. Once the update is complete, the product power turns off automatically.
  - If you turn off the power of the product while the software is being updated, it may cause a product malfunction.

### **The following only applies to models with a remote control**

- Do not let children use the remote control. Keep the remote control out of reach of toddlers.
- Do not let children put the remote control in their mouth. Make sure that children don't swallow the remote control cover or a battery. If a child swallowed one, consult a physician immediately.
- Beware that children may step on the remote control cover and get injured.
- Remove obstacles between the product and the remote control for the smooth operation of the remote control.

### **The following only applies to models that use optical discs**

- Do not insert your hand into a disc drive or pull it out forcefully.
- Make sure that children do not insert their hands into the disc drive.

### **The following only applies to models that able to watch video**

- Refrain from watching a 3D video if you didn't have enough sleep or after drinking alcohol.
  - Some 3D videos may surprise or excite people.
- If any of the following symptoms occur while watching a video, stop watching it immediately and take a rest.
  - If any of the symptoms continue, consult a physician. Vertigo, burning sensation of eyes or face, unconscious motion, spasm, clouded consciousness, confusion, disorientation, nausea.
- You may suffer a symptom such as a seizure when you watch a certain image in a video or game or a video with a certain pattern or flashing lights. If you or any of your relatives have a history of epilepsy or seizures, consult a physician before watching.
- When you watch a 3D video, remove objects that are fragile or can cause injury from your surroundings.
  - If you mistake a 3D video as real or move your body with surprise, you or your nearby relatives may get injured or objects near you may get damaged.

## **Precautions for cleaning the product**

---

- Do not spray water directly onto the product when cleaning it.
  - Otherwise, it may cause a fire or electric shock.
- When cleaning the product, make sure that you pull out the power cord first and wipe the surface of the product lightly with a dry cloth. Do not use chemicals or detergents when cleaning the product. They may deteriorate the product surface or peel off the paint from the product (benzene, alcohol, etc.).

# Before Reporting Product Malfunction

## Troubleshooting

If you experience the following issues while using the product, perform several checks, as they may not be malfunctions.

### General Errors

Issue	Solution
The product does not work properly	<ul style="list-style-type: none"><li>• Unplug the power cables and any external devices such as your TV or soundbar from the product, then plug them in again.</li><li>• After resetting the product, connect your smartphone and Wi-Fi again. (→ See “Connecting with the product via LG ThinQ app”) (Be aware that previous product settings may be lost.)</li></ul>
The power does not turn on	<ul style="list-style-type: none"><li>• Is the power cord plugged into the outlet properly?<ul style="list-style-type: none"><li>- Connect the power plug to the outlet correctly.</li></ul></li></ul>
There is no sound	<ul style="list-style-type: none"><li>• Is the volume set to minimum?<ul style="list-style-type: none"><li>- Press the <b>Volume</b>   button on the product to turn up the volume.</li><li>- If you are using an external device such as a portable device, or <b>Bluetooth</b> device, adjust the volume of the external device.</li></ul></li><li>• Is the correct product function selected according to the external device connected?<ul style="list-style-type: none"><li>- Press the <b>Source</b>  button to check if you selected the correct function.</li></ul></li></ul>
There is no sound from USB audio	<ul style="list-style-type: none"><li>• Run the <b>LG ThinQ app</b>, select the <b>Settings</b>  button on the first screen, and turn off the [Using USB Audio Class 2.0] function on the next screen. ( <b>On</b> &gt;  <b>Off</b>) To apply the configured settings, press and hold the <b>Power</b>  button for more than 3 seconds to turn off the product, then power it on again.</li></ul>
The Auto Power function does not work	<ul style="list-style-type: none"><li>• Check connection to external devices (ex. portable device, <b>Bluetooth</b> device).</li></ul>
The product fails to recognise a USB storage device	<ul style="list-style-type: none"><li>• The product may not support the file format of the USB storage device. Format the USB storage device and reconnect it. When formatting, refer to the USB storage device formats supported by the product and select an appropriate file format. (→ See “Connecting to a USB Storage Device”)</li></ul>

---

**A Bluetooth device cannot be paired**

- Press the Settings button on the **Bluetooth** device and check whether the **Bluetooth** function is enabled. If **Bluetooth** is enabled, turn it off and on, then try again.
  - Remove any obstacles between the product and the **Bluetooth** device.
  - **Bluetooth** pairing (connection) may not work properly depending on the **Bluetooth** device type or the surrounding environment.
-

## Network Connection Errors

Issue	Solution
<b>The product cannot be connected to the LG ThinQ app</b>	<ul style="list-style-type: none"><li>• The connection may not be smooth when disturbed by other electric appliances that use radio waves, such as microwave ovens and medical equipment. Install the product 1 m (3.3 ft) away from other home appliances.</li><li>• Turn off your wireless router and turn it on again.</li><li>• Check if your smartphone's Wi-Fi function is turned on. You can check the Wi-Fi connection status in your smartphone's settings.</li><li>• Check if the product and smartphone are on the same Wi-Fi network.</li></ul>
<b>The product does not connect to the Wi-Fi network</b>	<ul style="list-style-type: none"><li>• Did you turn off the wireless router and turn it on again?<ul style="list-style-type: none"><li>- Turn off the product and then turn it on again.</li></ul></li><li>• Have you installed a new wireless router?<ul style="list-style-type: none"><li>- You will need to reconfigure the network settings of the product. (→ See "Connecting with the product via LG ThinQ app")</li></ul></li><li>• Did you change the settings of the wireless router?<ul style="list-style-type: none"><li>- If the router password contains some special characters (such as ` ` " + / \ ; : - _ ^ &amp; ( ) &lt; &gt; ) or emoticons, the product may not be connected. It is recommended to set a password using a combination of English letters and numbers.</li><li>- It is recommended to set the security type of the wireless router to WPA2.</li></ul></li><li>• Unplug the router and plug it in after 10 seconds. Then try to connect after network recovery.</li><li>• Changing the wireless channel on your router can help reduce wireless interference. (Here is how to change the wireless channel of the most common routers. For the exact details, refer to your router's instruction manual.)<ol style="list-style-type: none"><li>① Enter the IP address on your smartphone, PC, or MAC, or use the setup wizard CD to log into the router setup page. This can only be done when the router is connected to the network via Wi-Fi or an Ethernet cable.</li><li>② Find the wireless settings page and change the wireless channel of your 2.4 GHz / 5 GHz network. If the "Auto" channel is enabled, disable it and set up a specific channel.<ul style="list-style-type: none"><li>- If the router channel is 2.4 GHz, 6 ch / 11 ch</li><li>- If the router channel is 5 GHz, 48 ch / 149 ch</li></ul></li><li>③ Save the settings and restart the wireless router.<ul style="list-style-type: none"><li>- Remove the power cable from the router, wait 5 seconds, and reconnect the power cable. When the router is completely powered on, try connecting it again.</li></ul></li></ol></li></ul>

## App Errors

Issue	Solution
The app is not working properly	<ul style="list-style-type: none"><li>Do you get an error when running the app?<ul style="list-style-type: none"><li>Check if the power of the device is turned on.</li><li>Check if the app you wish to run supports the operating system of your smartphone. You can visit the app manufacturer's website to confirm supported operating systems.</li><li>Check if you have the latest version of the app. Search for the app on Google Play or the App Store and check if an <b>Update</b> button appears next to it. If it is not the latest version, tap the <b>Update</b> button.</li></ul></li><li>If the error is not resolved yet, try connecting by using another smartphone with the <b>LG ThinQ app</b> installed.</li></ul>
Google Cast is not working properly	<ul style="list-style-type: none"><li>If Google Cast is not working properly after installing the product, you can resolve it in the <b>LG ThinQ app</b>.<ol style="list-style-type: none"><li>Make sure your smartphone is connected to the same Wi-Fi network as your speaker.</li><li>Install and launch the <b>LG ThinQ app</b>.</li><li>After launching the <b>LG ThinQ app</b>, follow the steps below to enable Google Cast function.<ul style="list-style-type: none"><li>Enter <b>Setting</b>  on the top right of the home screen → Enter 'Google Cast Settings' → Enter 'Activate' → Click the 'Agree' button.</li></ul></li></ol></li></ul>
The product may not appear in apps that support Google Cast, AirPlay, Spotify, or Tidal	<ul style="list-style-type: none"><li>If the product is connected via Dolby Atmos FLEXCONNECT or set as the "Other" device in Stereo mode, it may not be discoverable. Disable these modes.</li></ul>

## Problems in Wireless Connection

Issue	Solution
There is radio interference	<ul style="list-style-type: none"><li>• Do not install the product on metal furniture.</li><li>• Wireless communication may not work properly in weak signal areas.</li></ul>
The Bluetooth connection is causing a malfunction or making noise	<ul style="list-style-type: none"><li>• Do you hear noise or experience malfunctions when using <b>Bluetooth</b>?<ul style="list-style-type: none"><li>- Do not let any part of your body contact the transceiver of the <b>Bluetooth</b> device or the product.</li><li>- Do not install the <b>Bluetooth</b> device on a wall or in a secluded spot.</li><li>- Remove any obstacles between the product and the <b>Bluetooth</b> device.</li><li>- Install the <b>Bluetooth</b> device near the product.</li></ul></li><li>• When the <b>Bluetooth</b> device is too far from the product, <b>Bluetooth</b> may be disconnected or malfunctions may occur.<ul style="list-style-type: none"><li>- Install the <b>Bluetooth</b> device 1 m (3.3 ft) away from devices that use the same frequency as the product, such as wireless routers, medical equipment, and microwave ovens.</li></ul></li></ul>
Dolby Atmos FLEXCONNECT and Stereo mode connections are not working	<ul style="list-style-type: none"><li>• LG Sound Suite products do not support DFS (Dynamic Frequency Selection) channels. Disable DFS channels on your router and try reconnecting. The method for disabling DFS channels may vary depending on the router manufacturer, so refer to your router's manual.</li></ul>

# Appendix

## Specifications

General	
Power Requirements	Refer to the main label.
Power Consumption	Refer to the main label.
Dimensions (W x H x D)	<b>M7:</b> Approx. 177.0 mm x 238.3 mm x 177.0 mm (including the base) (7.0 inch x 9.4 inch x 7.0 inch) <b>M5:</b> Approx. 152.0 mm x 199.3 mm x 152.0 mm (including the base) (6.0 inch x 7.8 inch x 6.0 inch)
Operation Temperature Range	5 °C - 40 °C (41 °F to 104 °F)
Operation Humidity Range	5 % - 80 % RH
Bus Power Supply (USB)	5 V  500 mA (Type-C)
Available Digital Input Audio Sampling Frequency	32 kHz, 44.1 kHz, 48 kHz, 88.2 kHz, 96 kHz, 176.4 kHz, 192 kHz
Available Digital Input Audio format	Dolby Atmos, PCM

Input/Output	
USB	5 V (Type-C, USB terminal) × 1

System	
Wireless LAN (Internet antenna)	802.11a/b/g/n/ac/ax Wi-Fi network compatible

- Actual features, functionality, and other product specifications may differ and are subject to change without notice.

## | Registered Trademarks and Licenses

All trademarks and trade names are the property of their respective owners.



Dolby, Dolby Atmos, and the double-D symbol are registered trademarks of Dolby Laboratories Licensing Corporation. Manufactured under license from Dolby Laboratories. Confidential unpublished works. Copyright © 2012–2024 Dolby Laboratories. All rights reserved.



The **Bluetooth**® word mark and logos are registered trademarks owned by the **Bluetooth** SIG, Inc. and any use of such marks by LG Electronics is under license.

Other trademarks and trade names are those of their respective owners.

## | What You Need to Know about Network Services

All information, data, documents, correspondence, downloads, files, text, images, photos, graphics, videos, webcasts, publications, tools, resources, software, code, programs, applets, widgets, applications, products, and any other content ("Content") and services and offerings ("Services") made available by a third-party are provided under the sole responsibility of the service providers that produced them.

Withholding, removal, or suspension of any or all of these Content and Services are not restricted, and the use of and access to Contents and Services provided through LG Electronics products by the service providers may be changed anytime without prior notice.

If you have any demands or issues regarding Content and Services, you can refer to the service provider's website for the most up-to-date information. LG Electronics is not responsible for consumer services related to Content and Services, and does not undertake any obligations. Any questions or requirements regarding Content and Services should be fulfilled directly by the respective content and service providers.

It is clear that LG Electronics is not responsible for any Content or Services, or any change, removal, or suspension of each Content or Service, and does not certify or guarantee the use of or access to such Content or Services.

## | Open Source Software Notice Information

To obtain the source code that is contained in this product, under GPL, LGPL, MPL, and other open source licenses that have the obligation to disclose source code, and to access all referred license terms, copyright notices, please visit <https://opensource.lge.com>.

LG Electronics will also provide open source code to you for a charge covering the cost of performing such distribution upon email request to [opensource@lge.com](mailto:opensource@lge.com).

This offer is valid to anyone in receipt of this information for a period of three years after our last shipment of this product.

# | Handling the Product

## **When shipping the Product**

Please save the original shipping carton and packing materials. If you need to ship the product, for maximum protection, re-pack the product as it was originally packed at the factory.

## **Keeping the exterior surfaces clean**

- Do not use volatile liquids such as insecticide spray near the product.
- Wiping with strong pressure may damage the surface.
- Do not leave rubber or plastic products in contact with the product for a long period of time.

## **Cleaning the product**

To clean the product, use a soft, dry cloth. If the surfaces are extremely dirty, use a soft cloth lightly moistened with a mild detergent solution. Do not use strong solvents such as alcohol, benzene, or thinner, as these might damage the surface of the product.

